



# Accessories

## Aluminum Duplex Sleeves (Hour glass shape)



Code	For cable diameter in.	Weight / each approx. lbs.
AOS-132	1/32	.0002
AOS-364	3/64	.001
AOS-116	1/16	.001
AOS-564	5/64	.002
AOS-332	3/32	.003
AOS-018	1/8	.006
AOS-532	5/32	.008
AOS-316	3/16	.016
AOS-732	7/32	.022
AOS-014	1/4	.025
AOS-516	5/16	.045
AOS-038	3/8	.061
AOS-716	7/16	.118
AOS-012	1/2	.176

## Aluminum Oval Sleeves



Code	For cable diameter in.	Weight / each approx. lbs.
AOS-058OVALE	9/16 – 5/8	.220
AOS-034OVALE	3/4	.400
AOS-078OVALE	7/8	.674
AOS-001OVALE	1	-
AOS-114OVALE	1 1/4	1.922

*Other sizes available on request.*



COS



CZOS

## Copper Duplex Sleeves or Copper Zinc Plated Duplex Sleeves

Code Copper	Code Copper Zinc Plated	For cable diameter in.	Weight / each approx. lbs.
COS-132	CZOS-132	1/32	.001
COS-364	CZOS-364	3/64	.002
COS-116	CZOS-116	1/16	.003
COS-332	CZOS-332	3/32	.005
COS-018	CZOS-018	1/8	.016
COS-532	CZOS-532	5/32	.022
COS-316	CZOS-316	3/16	.051
COS-732	CZOS-732	7/32	.044
COS-014	CZOS-014	1/4	.078
COS-516	CZOS-516	5/16	.115
COS-038	CZOS-038	3/8	.146
COS-012	CZOS-012	1/2	.372

**Easier  
Insertion**

## Aluminum Stop Sleeves, *chamfered*



Code	For cable diameter in.	Weight / each approx. lbs.
ASS-116	1/16	.001
ASS-564	5/64	.002
ASS-332	3/32	.003
ASS-018	1/8	.002
ASS-532	5/32	.004
ASS-316	3/16	.004
ASS-014	1/4	.021
ASS-516	5/16	.022
ASS-038	3/8	.022



## Copper Stop Sleeves

Code	For cable diameter in.	Weight / each approx. lbs.
CSS-132	1/32	.001
CSS-364	3/64	.002
CSS-116	1/16	.002
CSS-332	3/32	.008
CSS-018	1/8	.007
CSS-532	5/32	.012
CSS-316	3/16	.105
CSS-732	7/32	.186
CSS-014	1/4	.061
CSS-516	5/16	.052



## Steel Sleeves

Code	Rope Size in.	Weight per 100 lbs	Before Swage Dimensions in.					After Swage Dimensions in. (max)
			C	E	M	N	O	Standard Die
BAS505-014	1/4	5	.66	1.00	.31	.47	.28	.57
BAS505-516	5/16	14	.91	1.50	.38	.62	.44	.75
BAS505-038	3/8	14	.91	1.50	.47	.66	.39	.75
BAS505-716	7/16	33	1.22	2.00	.53	.85	.65	1.01
BAS505-012	1/2	29	1.22	2.00	.63	.91	.56	1.01
BAS505-916	9/16	64	1.47	2.75	.70	1.03	.63	1.24
BAS505-058	5/8	56	1.47	2.75	.75	1.09	.63	1.24
BAS505-034	3/4	88	1.72	3.19	.91	1.28	.84	1.46
BAS505-078	7/8	131	2.03	3.56	1.03	1.53	1.00	1.68
BAS505-001	1	195	2.28	4.00	1.16	1.72	1.13	1.93
BAS505-118	1 1/8	260	2.50	4.81	1.28	1.94	1.25	2.13
BAS505-114	1 1/4	355	2.78	5.19	1.44	2.16	1.41	2.32
BAS505-138	1 3/8	423	3.00	5.81	1.56	2.38	1.56	2.52
BAS505-112	1 1/2	499	3.25	6.25	1.69	2.63	1.69	2.71
BAS505-134	1 3/4	805	3.84	7.25	1.94	3.13	1.97	3.10
BAS505-002	2	1,132	4.38	8.50	2.25	3.63	2.25	3.56
BAS505-214	2 1/4	1,936	5.03	9.56	2.50	4.03	2.53	4.12
BAS505-212	2 1/2	2,352	5.50	10.50	2.75	4.50	2.81	4.50

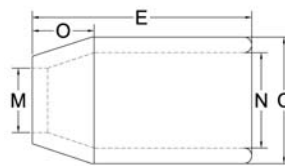

## Steel Swage Buttons

Code	Weight / ea. approx. lbs.	Dimensions (in.)		
		A	C	D
SBS409018	.02	0.438	0.526	0.141
SBS409316	.04	0.568	0.737	0.203
SBS409014	.07	0.632	1.000	0.281
SBS409516	.15	0.852	1.150	0.344
SBS409038	.20	0.875	1.500	0.406
SBS409716	.39	1.136	1.684	0.469
SBS409012	.54	1.278	1.840	0.531
SBS409916	.73	1.420	2.040	0.594
SBS409058	1.07	1.562	2.421	0.656
SBS409034	1.36	1.704	2.720	0.797
SBS409078	2.24	2.000	3.263	0.938
SBS409001	3.27	2.272	3.684	1.063
SBS409118	4.59	2.563	4.050	1.187
SBS409114	7.89	2.840	4.560	1.320
SBS409112	11.01	3.408	5.470	1.578

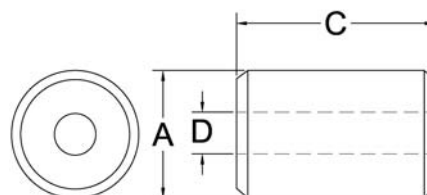

Properly swaged aluminum and copper oval sleeves and duplex will develop the published nominal break strength of the cable on 3x7, 7x7, and 7x19 constructions. Sleeves used on other constructions will not hold to the nominal published break strength.

Stop sleeves will not hold to the nominal published break strength of any cable.

We recommend the use of a mechanical or hydraulic swager to obtain the full holding power of stainless steel oval sleeves.

Sleeves and other fittings swaged over a plastic jacket will not hold to the nominal published break strength of the cable.

To determine the actual holding strength of any fitting a pull test must be made.

This will assist in determining if the applied fitting is suitable for your application.

EYE-SPLICE - OVAL SLEEVE OR DUPLEX

STOP SLEEVE



LAP SPLICE - OVAL SLEEVES OR DUPLEX



### AN Thimbles (zinc plated)

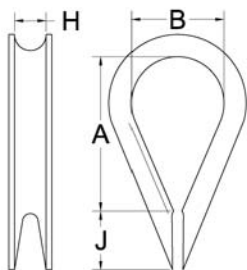

Code	For cable diameter in.	Weight / ea. approx. lbs.	Dimensions in.			
			A	B	H	J
ANTZ-116	3/64 – 1/16 – 5/64	.002	43/64	.350	3/32	3/16
ANTZ-018	3/32 – 7/64 – 1/8	.004	45/64	.350	9/64	7/32
ANTZ-532	5/32	.006	51/64	.400	11/64	7/32
ANTZ-316	3/16	.010	1	.500	13/64	5/16
ANTZ-014	7/32 – 1/4	.015	1 13/32	.700	17/64	13/32
ANTZ-516	9/32 – 5/16	.035	1 51/64	.900	21/64	7/16
ANTZ-038	3/8	.085	2	1.000	25/64	5/8

### Standard Thimbles (galvanized)

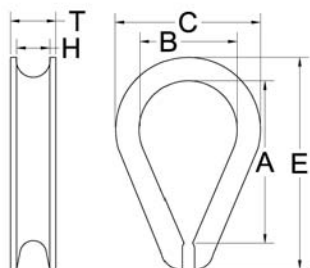

Code	For cable diameter in.	Weight / ea. approx. lbs.	Dimensions in.					
			A	B	C	E	H	T
STDTG-018	1/8 – 5/32	.035	1.31	.69	1.06	1.94	.16	.25
STDTG-316	3/16	.035	1.31	.69	1.06	1.94	.22	.31
STDTG-014	1/4	.035	1.31	.69	1.06	1.94	.28	.38
STDTG-516	5/16	.040	1.50	.81	1.25	2.13	.34	.44
STDTG-038	3/8	.075	1.63	.94	1.47	2.38	.41	.53
STDTG-012	1/2	.140	1.88	1.13	1.75	2.75	.53	.69
STDTG-058	5/8	.360	2.25	1.38	2.38	3.50	.66	.91
STDTG-034	3/4	.500	2.50	1.63	2.69	3.75	.78	1.08
STDTG-078	7/8	.900	3.50	1.88	3.19	5.00	.94	1.27
STDTG-001	1	1.04	4.25	2.50	3.75	5.69	1.06	1.39

**Federal Specification : FF-T-276B** Other dimensions available upon request.

### HD Thimbles (galvanized)

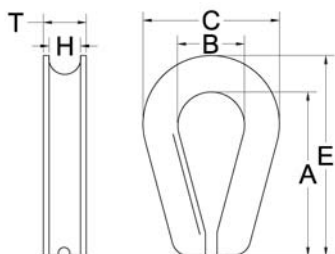

Code	For cable diameter in.	Weight / ea. approx. lbs.	Dimensions in.					
			A	B	C	E	H	T
HDTG-014	1/4	0.080	1.62	.88	1.50	2.19	.28	.41
HDTG-516	5/16	0.140	1.88	1.06	1.81	2.50	.34	.50
HDTG-038	3/8	0.260	2.12	1.12	2.12	2.88	.41	.63
HDTG-716	7/16	0.300	2.38	1.25	2.38	3.25	.47	.72
HDTG-012	1/2	0.440	2.75	1.50	2.75	3.62	.59	.89
HDTG-916	9/16	0.510	2.75	1.50	2.75	3.62	.59	.89
HDTG-058	5/8	0.740	3.25	1.75	3.12	4.25	.66	1.00
HDTG-034	3/4	1.150	3.75	2.00	3.81	5.00	.78	1.22
HDTG-078	7/8	1.500	4.25	2.25	4.25	5.50	.94	1.38
HDTG-001	1	2.250	4.50	2.50	4.75	6.12	1.06	1.56
HDTG-114	1 1/8 – 1 1/4	3.360	5.12	2.88	5.88	7.00	1.31	1.88
HDTG-138	1 1/4 – 1 3/8	8.17	6.50	3.50	6.81	9.08	1.44	2.25
HDTG-112	1 1/2	10.00	6.25	3.50	7.12	9.00	1.56	2.62
HDTG-002	2	27.75	12.00	6.00	10.38	15.12	2.09	3.38

**Federal Specification : FF-T-276B** Other dimensions available upon request.



## Round Eye Thimbles (zinc)

Code	For cable diameter in.	Dimensions in.		Weight / ea.
		E	G	
RETZC-018281	3/32 – 1/8	0.625	0.281	0.02
RETZC-018359	3/32 – 1/8	0.625	0.359	0.02

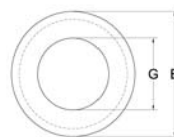

## Solid Wire Rope Thimbles

Code	Cable diameter	Weight / ea. lbs.	Dimensions in.			
			C	E	G	T
S412-012	1/2	2.25	2 1/8	2 13/16	1	7/8
S412-058	5/8	6.00	3 3/8	4 11/16	1 3/16	1 1/8
S412-034	3/4	5.12	3 3/8	4 11/16	1 3/8	1 3/8
S412-078	7/8	10.00	4 1/2	6 1/16	1 5/8	1 5/8
S412-001	1	10.00	4 1/2	6 1/16	2	1 13/16
S412-118	1 1/8	10.00	5 3/8	7 1/4	2 1/4	2 1/16
S412-114	1 1/4 — 1 3/8	10.00	5 3/8	7 1/4	2 1/2	2 5/16

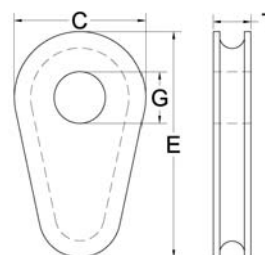

## Eye & Eye Swivels (forged steel galvanized)

Code	Diameter in.	Working Load Limit lbs.	Weight / ea. lbs.	Dimensions in.	
				B	F
G402-014	1/4	850	0.21	3/4	2 15/16
G402-516	5/16	1,250	0.39	1	3 9/16
G402-038	3/8	2,250	0.75	1 1/4	4 5/16
G402-012	1/2	3,600	1.43	1 1/2	5 7/16
G402-058	5/8	5,200	2.50	1 3/4	6 9/16
G402-034	3/4	7,200	4.13	2	7 3/16
G402-078	7/8	10,000	6.25	2 1/4	8 3/8
G402-001	1	12,500	9.00	2 1/2	9 5/8

Safety Factor 5:1

Federal Specification : RR-C-271D

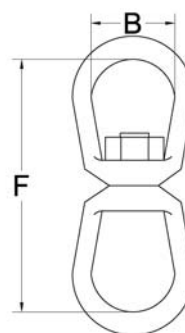

## Jaw & Eye Swivels (forged steel galvanized)

Code	Diameter in.	Working Load Limit lbs.	Weight / ea. lbs.	Dimensions in.		
				B	F	H
G403-014	1/4	850	0.25	3/4	2 5/8	15/32
G403-516	5/16	1,250	0.37	1	2 15/16	1/2
G403-038	3/8	2,250	0.70	1 1/4	3 5/8	5/8
G403-012	1/2	3,600	1.43	1 1/2	4 1/2	3/4
G403-058	5/8	5,200	2.48	1 3/4	5 5/16	15/16
G403-034	3/4	7,200	3.88	2	6 1/16	1 1/8
G403-078	7/8	10,000	5.75	2 1/4	7	1 3/16
G403-001	1	12,500	10.25	2 1/2	8 9/16	1 3/4

Safety Factor 5:1

Federal Specification : RR-C-271D

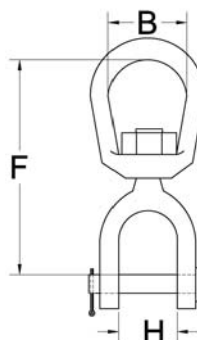



### Wire Rope Clips (malleable, zinc plated)

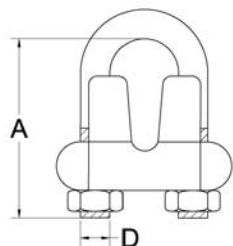

Code	For cable diameter in.	Weight / ea. lbs.	Dimensions in.		Nut Torque ft/lbs	Wire Rope Clips Min. Qty	Turn Back Length in.
			A Minimum	D Minimum			
WRCMA-116	1/16	0.03	0.630	8 - 32	1.0	2	3
WRCMA-018	3/32 - 1/8	0.04	0.780	10 - 24	1.8	2	3 1/4
WRCMA-316	3/16	0.06	0.875	10 - 24	2.6	2	3 3/4
WRCMA-014	1/4	0.12	1.188	5/16 - 18	12	3	4 3/4
WRCMA-516	5/16	0.14	1.188	5/16 - 18	12	3	5 1/4
WRCMA-038	3/8	0.21	1.563	3/8 - 16	18.5	4	6 1/2
WRCMA-716	7/16	0.27	1.625	3/8 - 16	18.5	4	7
WRCMA-012	1/2	0.35	2.000	7/16 - 14	25	4	11 1/2
WRCMA-058	5/8	0.58	2.313	1/2 - 13	35	-	12
WRCMA-034	3/4	0.84	2.563	9/16 - 12	50	-	18
WRCMA-078	7/8	1.24	3.063	5/8 - 11	100	-	19
WRCMA-001	1	1.50	3.375	5/8 - 11	100	-	26
WRCMA-118	1 1/8	2.60	3.875	3/4 - 10	140	-	34
WRCMA-114	1 1/4	?	3.875	3/4 - 10	140	-	44

**Federal Specification : FF-C-450** *Other dimensions available upon request.*

### Instructions for use of Wire Rope Clips :

Wire rope clips are not to be used on coated cable without first stripping off the coating. Apply U-Bolt over dead end of wire rope. Live end rests in saddle. (Never saddle a dead horse !)

See following table for indications concerning quantity of clips to be installed and "turn back" lengths required on specific diameters of rope. These indications are valid for most cable "constructions". Please contact our specialists for more information.

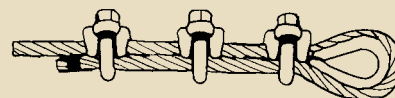

### Wire Rope Clips (drop-forged, galvanized)

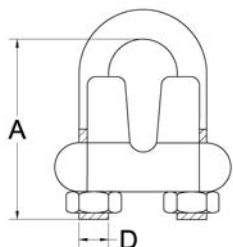

Code	For cable diameter in.	Weight / ea. lbs.	Dimensions in.		Nut Torque ft/lbs	Wire Rope Clips Min. Qty	Turn Back Length in.
			A Minimum	D Minimum			
WRCDF-018	1/8	0.06	0.719	12 - 24	2.8	2	3 1/4
WRCDF-316	3/16	0.10	0.938	1/4 - 20	5.5	2	3 3/4
WRCDF-014	1/4	0.19	1.031	5/16 - 18	12	2	4 3/4
WRCDF-516	5/16	0.28	1.313	3/8 - 16	18.5	2	5 1/4
WRCDF-038	3/8	0.48	1.500	7/16 - 14	25	2	6 1/2
WRCDF-716	7/16	0.76	1.875	1/2 - 13	35	2	7
WRCDF-012	1/2	0.80	1.875	1/2 - 13	35	3	11 1/2
WRCDF-916	9/16	1.04	2.250	9/16 - 12	50	3	12
WRCDF-058	5/8	1.10	2.375	9/16 - 12	50	3	12
WRCDF-034	3/4	1.42	2.750	5/8 - 11	100	4	18
WRCDF-078	7/8	2.12	3.125	3/4 - 10	140	4	19
WRCDF-001	1	2.52	3.500	3/4 - 10	140	5	26
WRCDF-118	1 1/8	2.90	3.875	3/4 - 10	140	6	34
WRCDF-114	1 1/4	4.30	4.250	7/8 - 9	275	7	44

**Federal Specification : FF-C-450** *Other dimensions available upon request.*



## Galvanized Turnbuckles, drop-forged

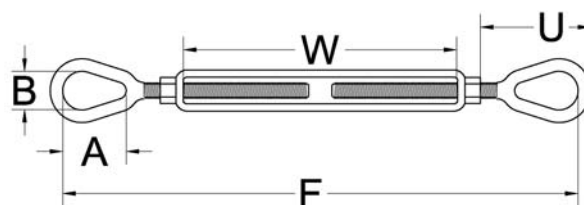

### Galvanized Turnbuckles (EYE & EYE), drop-forged

Code	Thread Dia. x Take-Up in.	Working Load Limit lbs	Weight Each lbs	Dimensions in.					
				A	B	F Open	F Closed	U Closed	W
TEEG-01404	1/4 x 4	500	0.26	.78	.34	11.80	7.80	1.75	4.00
TEEG-516412	5/16 x 4 1/2	800	0.45	.94	.44	13.56	9.06	2.09	4.50
TEEG-03806	3/8 x 6	1,200	0.75	1.12	.53	17.47	11.47	2.52	6.00
TEEG-01206	1/2 x 6	2,200	1.50	1.44	.72	20.08	13.08	3.23	6.00
TEEG-01209	1/2 x 9	2,200	1.75	1.44	.72	26.08	16.08	3.23	9.00
TEEG-01212	1/2 x 12	2,200	2.18	1.44	.72	32.08	19.08	3.23	12.00
TEG-05806	5/8 x 6	3,500	2.63	1.75	.88	21.93	14.68	3.90	6.00
TEEG-05809	5/8 x 9	3,500	3.00	1.75	.88	27.93	17.68	3.90	9.00
TEEG-05812	5/8 x 12	3,500	3.25	1.75	.88	33.93	20.68	3.90	12.00
TEEG-03406	3/4 x 6	5,200	3.75	2.09	1.00	23.88	16.38	4.69	6.00
TEEG-03409	3/4 x 9	5,200	4.50	2.09	1.00	29.88	19.38	4.69	9.00
TEEG-03412	3/4 x 12	5,200	5.75	2.09	1.00	35.88	22.38	4.69	12.00
TEEG-03418	3/4 x 18	5,200	7.00	2.09	1.00	47.88	28.38	4.69	18.00
TEEG-07812	7/8 x 12	7,200	8.35	2.38	1.25	37.07	23.32	5.10	12.00
TEEG-07818	7/8 x 18	7,200	10.25	2.38	1.25	49.07	29.32	5.10	18.00
TEEG-00106	1 x 6	10,000	9.04	3.00	1.44	27.97	19.97	6.36	6.00
TEEG-00112	1 x 12	10,000	11.25	3.00	1.44	39.97	25.97	6.36	12.00
TEEG-00118	1 x 18	10,000	14.0	3.00	1.44	51.97	31.97	6.36	18.00
TEEG-00124	1 x 24	10,000	17.0	3.00	1.44	63.97	37.97	6.36	24.00
TEEG-11412	1 1/4 x 12	15,200	19.0	3.56	1.81	42.81	28.31	7.72	12.00
TEEG-11418	1 1/4 x 18	15,200	24.1	3.56	1.81	54.81	34.31	7.72	18.00
TEEG-11424	1 1/4 x 24	15,200	27.0	3.56	1.81	66.81	40.31	7.72	24.00
TEEG-11212	1 1/2 x 12	21,400	27.0	4.06	2.12	45.50	30.50	8.62	12.00
TEEG-11218	1 1/2 x 18	21,400	31.2	4.06	2.12	57.50	36.50	8.62	18.00
TEEG-11224	1 1/2 x 24	21,400	38.2	4.06	2.12	69.50	42.50	8.62	24.00
TEEG-13418	1 3/4 x 18	28,000	45.0	4.62	2.38	57.38	39.38	10.00	18.00
TEEG-13424	1 3/4 x 24	28,000	58.0	4.62	2.38	69.38	45.38	10.00	24.00
TEEG-00224	2 x 24	37,000	85.0	5.75	2.69	75.69	51.69	13.09	24.00
TEEG-21224	2 1/2 x 24	60,000	148.0	6.50	3.12	78.62	54.62	13.78	24.00
TEEG-23424	2 3/4 x 24	75,000	180.0	7.00	3.25	81.00	57.00	15.22	24.00

Safety Factor 5:1

Federal Specification : FF-T-791B Other dimensions available upon request.

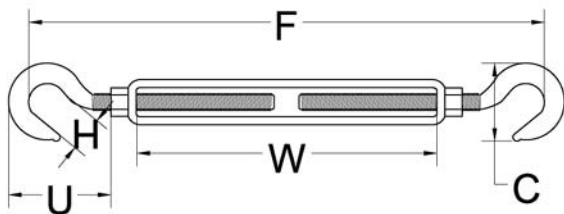

### Galvanized Turnbuckles (HOOK & HOOK), drop-forged

Code	Thread Dia. x Take-Up in.	Working Load Limit lbs	Weight Each lbs	Dimensions in.					
				C	F Open	F Closed	H	U Closed	W
THHG-01404	1/4 x 4	400	0.26	1.27	11.12	7.12	.45	1.59	4.00
THHG-516412	5/16 x 4 1/2	700	0.45	1.50	12.81	8.31	.50	1.94	4.50
THHG-03806	3/8 x 6	1,000	0.75	1.77	16.50	10.50	.56	2.30	6.00
THHG-01206	1/2 x 6	1,500	1.50	2.28	18.82	11.82	.66	2.94	6.00
THHG-01209	1/2 x 9	1,500	1.75	2.28	24.82	14.82	.66	2.94	9.00
THHG-01212	1/2 x 12	1,500	2.18	2.28	30.82	17.82	.66	2.94	12.00
THHG-05806	5/8 x 6	2,250	2.63	2.81	20.50	13.25	.90	3.69	6.00
THHG-05809	5/8 x 9	2,250	3.00	2.81	26.50	16.25	.90	3.69	9.00
THHG-05812	5/8 x 12	2,250	3.25	2.81	32.50	19.25	.90	3.69	12.00
THHG-03406	3/4 x 6	3,000	3.75	3.33	22.38	14.88	.98	4.52	6.00
THHG-03409	3/4 x 9	3,000	4.50	3.33	28.38	17.88	.98	4.52	9.00
THHG-03412	3/4 x 12	3,000	5.75	3.33	34.38	20.88	.98	4.52	12.00
THHG-03418	3/4 x 18	3,000	7.00	3.33	46.38	26.88	.98	4.52	18.00
THHG-07812	7/8 x 12	4,000	8.35	3.78	36.00	22.25	1.13	5.19	12.00
THHG-07818	7/8 x 18	4,000	10.25	3.78	48.00	28.25	1.13	5.19	18.00
THHG-00106	1 x 6	5,000	9.04	4.25	25.63	17.63	1.25	5.84	6.00
THHG-00112	1 x 12	5,000	11.25	4.25	37.63	23.63	1.25	5.84	12.00
THHG-00118	1 x 18	5,000	14.0	4.25	49.63	29.63	1.25	5.84	18.00
THHG-00124	1 x 24	5,000	17.0	4.25	61.63	35.63	1.25	5.84	24.00
THHG-11412	1 1/4 x 12	6,500	19.0	5.13	40.50	26.50	1.50	7.22	12.00
THHG-11418	1 1/4 x 18	6,500	24.1	5.13	52.50	32.50	1.50	7.22	18.00
THHG-11424	1 1/4 x 24	6,500	27.0	5.13	64.50	38.50	1.50	7.22	24.00
THHG-11212	1 1/2 x 12	7,500	27.0	5.75	43.50	30.50	1.88	8.34	12.00
THHG-11218	1 1/2 x 18	7,500	31.2	5.75	55.50	36.50	1.88	8.34	18.00
THHG-11224	1 1/2 x 24	7,500	38.2	5.75	67.50	42.50	1.88	8.34	24.00

Safety Factor 5:1

Federal Specification : FF-T-791B Other dimensions available upon request.

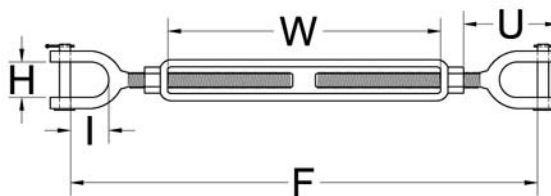

### Galvanized Turnbuckles (JAW & JAW), drop-forged

Code	Thread Dia. x Take-Up in.	Working Load Limit lbs	Weight Each lbs	Dimensions in.					
				F Open	F Closed	H	I	U Closed	W
TJJG-01404	1/4 x 4	500	0.36	10.90	6.90	.45	.62	1.58	4.00
TJJG-516412	5/16 x 4 1/2	800	0.52	12.36	8.36	.50	.87	1.98	4.50
TJJG-03806	3/8 x 6	1,200	0.93	16.14	10.14	.54	.87	2.12	6.00
TJJG-01206	1/2 x 6	2,200	1.68	18.50	11.50	.65	1.06	2.75	6.00
TJJG-01209	1/2 x 9	2,200	1.85	24.50	14.50	.65	1.06	2.75	9.00
TJJG-01212	1/2 x 12	2,200	2.20	30.50	17.50	.65	1.06	2.75	12.00
TJJ-05806	5/8 x 6	3,500	2.82	20.05	12.80	.79	1.31	3.50	6.00
TJJG-05809	5/8 x 9	3,500	3.25	26.05	15.80	.79	1.31	3.50	9.00
TJJG-05812	5/8 x 12	3,500	3.75	32.05	18.80	.79	1.31	3.50	12.00
TJJG-03406	3/4 x 6	5,200	4.68	21.50	14.00	.94	1.50	4.18	6.00
TJJG-03409	3/4 x 9	5,200	5.36	27.50	17.00	.94	1.50	4.18	9.00
TJJG-03412	3/4 x 12	5,200	6.12	33.50	20.00	.94	1.50	4.18	12.00
TJJG-03418	3/4 x 18	5,200	7.75	45.50	26.00	.94	1.50	4.18	18.00
TJJG-07812	7/8 x 12	7,200	9.38	35.11	21.36	1.13	1.75	4.85	12.00
TJJG-07818	7/8 x 18	7,200	11.44	47.11	27.36	1.13	1.75	4.85	18.00
TJJG-00106	1 x 6	10,000	10.20	24.72	16.72	1.34	2.06	5.53	6.00
TJJG-00112	1 x 12	10,000	12.88	36.72	22.72	1.34	2.06	5.53	12.00
TJJG-00118	1 x 18	10,000	16.10	48.72	28.72	1.34	2.06	5.53	18.00
TJJG-00124	1 x 24	10,000	18.60	60.72	34.72	1.34	2.06	5.53	24.00
TJJG-11412	1 1/4 x 12	15,200	23.60	39.84	25.34	1.75	2.81	7.21	12.00
TJJG-11418	1 1/4 x 18	15,200	26.60	51.84	31.34	1.75	2.81	7.21	18.00
TJJG-11424	1 1/4 x 24	15,200	29.00	63.84	37.34	1.75	2.81	7.21	24.00
TJJG-11212	1 1/2 x 12	21,400	35.50	41.50	26.50	2.06	2.81	7.88	12.00
TJJG-11218	1 1/2 x 18	21,400	40.70	53.50	32.50	2.06	2.81	7.88	18.00
TJJG-11224	1 1/2 x 24	21,400	47.60	65.50	38.50	2.06	2.81	7.88	24.00
TJJG-13418	1 3/4 x 18	28,000	52.40	53.38	35.38	2.60	3.38	9.40	18.00
TJJG-13424	1 3/4 x 24	28,000	64.00	65.38	41.38	2.60	3.38	9.40	24.00
TJJG-00224	2 x 24	37,000	94.00	69.54	45.54	2.62	3.69	11.86	24.00
TJJG-21224	2 1/2 x 24	60,000	175.00	72.98	48.98	3.06	4.44	13.56	24.00
TJJG-23424	2 3/4 x 24	75,000	248.00	74.75	50.75	3.63	4.19	15.22	24.00

Safety Factor 5:1

**Federal Specification : FF-T-791B** Other dimensions available upon request.

Forged jaw ends are fitted with bolts and nuts for 1/4" through 5/8", and pin cotters on 3/4" through 2 3/4" sizes.

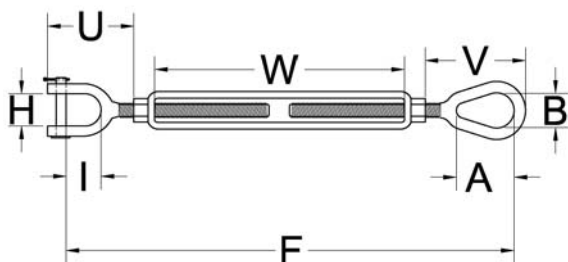

### Galvanized Turnbuckles (JAW & EYE), drop-forged

Code	Thread Dia. x Take-Up in.	Working Load Limit lbs	Weight Each lbs	Dimensions in.								
				A	B	F Open	F Closed	H	I	U Closed	V Closed	W
TJEG-01404	1/4 x 4	500	.30	.78	.34	11.35	7.35	.45	.62	1.58	1.75	4.00
TJEG-516412	5/16 x 4 1/2	800	.50	.94	.44	13.71	8.71	.50	.87	1.98	2.09	4.50
TJEG-03806	3/8 x 6	1,200	.80	1.12	.53	16.81	10.81	.54	.87	2.12	2.52	6.00
TJEG-01206	1/2 x 6	2,200	1.51	1.44	.72	19.29	12.29	.65	1.06	2.75	3.23	6.00
TJEG-01209	1/2 x 9	2,200	1.71	1.44	.72	25.29	15.29	.65	1.06	2.75	3.23	9.00
TJEG-01212	1/2 x 12	2,200	2.08	1.44	.72	31.29	18.29	.65	1.06	2.75	3.23	12.00
TJEG-05806	5/8 x 6	3,500	2.35	1.75	.88	20.99	13.74	.79	1.31	3.50	3.90	6.00
TJEG-05809	5/8 x 9	3,500	3.17	1.75	.88	26.99	16.74	.79	1.31	3.50	3.90	9.00
TJEG-05812	5/8 x 12	3,500	3.61	1.75	.88	32.99	19.74	.79	1.31	3.50	3.90	12.00
TJEG-03406	3/4 x 6	5,200	4.00	2.09	1.00	22.69	15.19	.94	1.50	4.18	4.69	6.00
TJEG-03409	3/4 x 9	5,200	4.75	2.09	1.00	28.69	18.19	.94	1.50	4.18	4.69	9.00
TJEG-03412	3/4 x 12	5,200	5.93	2.09	1.00	34.69	21.19	.94	1.50	4.18	4.69	12.00
TJEG-03418	3/4 x 18	5,200	7.00	2.09	1.00	46.69	27.19	.94	1.50	4.18	4.69	18.00
TJEG-07812	7/8 x 12	7,200	8.36	2.38	1.25	36.09	22.34	1.13	1.75	4.85	5.10	12.00
TJEG-07818	7/8 x 18	7,200	9.75	2.38	1.25	48.09	28.34	1.13	1.75	4.85	5.10	18.00
TJEG-00106	1 x 6	10,000	8.92	3.00	1.44	26.34	18.34	1.34	2.06	5.53	6.36	6.00
TJEG-00112	1 x 12	10,000	11.20	3.00	1.44	38.34	24.34	1.34	2.06	5.53	6.36	12.00
TJEG-00118	1 x 18	10,000	13.30	3.00	1.44	50.34	30.34	1.34	2.06	5.53	6.36	18.00
TJEG-00124	1 x 24	10,000	17.00	3.00	1.44	62.34	36.34	1.34	2.06	5.53	6.36	24.00
TJEG-11412	1 1/4 x 12	15,200	19.42	3.56	1.81	41.32	26.82	1.75	2.81	7.21	7.72	12.00
TJEG-11418	1 1/4 x 18	15,200	24.18	3.56	1.81	53.32	32.82	1.75	2.81	7.21	7.72	18.00
TJEG-11424	1 1/4 x 24	15,200	28.50	3.56	1.81	65.32	38.82	1.75	2.81	7.21	7.72	24.00
TJEG-11212	1 1/2 x 12	21,400	28.99	4.06	2.12	43.50	28.50	2.06	2.81	7.88	8.62	12.00
TJEG-11218	1 1/2 x 18	21,400	35.00	4.06	2.12	55.50	34.50	2.06	2.81	7.88	8.62	18.00
TJEG-11224	1 1/2 x 24	21,400	39.18	4.06	2.12	67.50	40.50	2.06	2.91	7.88	8.62	24.00
TJEG-13418	1 3/4 x 18	28,000	53.75	4.62	2.38	53.38	37.38	2.60	3.38	9.40	10.00	18.00
TJEG-13424	1 3/4 x 24	28,000	60.68	4.62	2.38	67.38	43.38	2.60	3.38	9.40	10.00	24.00
TJEG-00224	2 x 24	37,000	89.00	5.75	2.69	72.62	48.62	2.62	3.69	11.86	11.86	24.00
TJEG-21224	2 1/2 x 24	60,000	165.00	6.50	3.12	75.80	51.80	3.06	4.44	13.56	13.78	24.00
TJEG-23424	2 3/4 x 24	75,000	183.00	7.00	3.25	77.88	53.88	3.68	4.19	15.22	15.22	24.00

Safety Factor 5:1

**Federal Specification : FF-T-791B** Other dimensions available upon request.

Forged jaw ends are fitted with bolts and nuts for 1/4" through 5/8", and pin cutters on 3/4" through 2 3/4" sizes.



## Stub end Turnbuckles, self colored, drop forged

Code	Size Diameter x Take-Up in.	Working Load Limit lbs.	Weight / ea. lbs.	Dimensions in.			
				E	F	U	W
TSE-03806	3/8 x 6	1,200	0.75	7.13	16.0	4.44	6.0
TSE-01206	1/2 x 6	2,200	1.25	7.50	16.0	4.25	6.0
TSE-01209	1/2 x 9	2,200	1.70	10.50	19.0	4.25	9.0
TSE-05806	5/8 x 6	3,500	2.11	7.88	16.0	4.06	6.0
TSE-03406	3/4 x 6	5,200	3.27	8.25	17.0	4.38	6.0
TSE-03409	3/4 x 9	5,200	3.90	11.25	20.0	4.38	9.0
TSE-07806	7/8 x 6	7,200	4.78	8.63	18.0	4.69	6.0
TSE-00106	1 x 6	10,000	6.36	9.00	19.0	5.00	6.0
TSE-00112	1 x 12	10,000	8.80	15.00	25.0	5.00	12.0
TSE-11806	1 1/8 x 6	12,400	8.88	9.13	19.0	4.94	6.0
TSE-11406	1 1/4 x 6	15,200	10.18	9.13	20.0	5.44	6.0
TSE-11412	1 1/4 x 12	15,200	13.60	15.12	26.0	5.44	12.0
TSE-11212	1 1/2 x 12	21,400	20.44	15.75	26.5	5.38	12.0

Safety Factor 5:1

Federal Specification : FF-T-791B

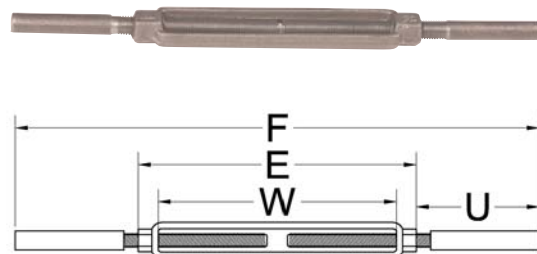

## Turnbuckles (body only) galvanized, drop forged

Code	Size Diameter x Take-Up in.	Working Load Limit lbs.	Weight / ea. lbs.	Dimensions in.		
				C	E	W
TBG-03806	3/8 x 6	1,200	0.29	.88	7.12	6.00
TBG-01206	1/2 x 6	2,200	0.60	1.12	7.50	6.00
TBG-05806	5/8 x 6	3,500	0.90	1.38	7.88	6.00
TBG-03406	3/4 x 6	5,200	1.30	1.69	8.25	6.00
TBG-00106	1 x 6	10,000	2.48	2.25	9.00	6.00
TBG-00112	1 x 12	10,000	3.93	2.25	15.00	12.00

Safety Factor 5:1

Federal Specification : FF-T-791B Other diameters and/or color available upon request.

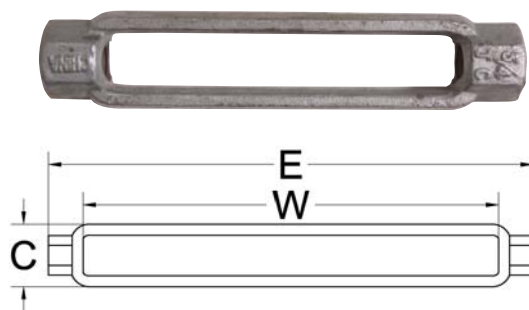

## Zinc Die Cast Ben-Mor Turnbuckles

Code H & E	Thread Diameter x Take-Up in.	Working Load Limit lbs	Weight /ea. lbs	B	F Closed	H	U1 Closed	U2 Closed	W
THEZ-014218	1/4 x 2 1/8	150	0.17	0.425	4.750	0.375	0.375	0.950	2.375
THEZ-516258	5/16 x 2 5/8	225	0.25	0.425	5.750	0.445	0.445	1.300	2.625
THEZ-038003	3/8 x 3	300	0.41	0.500	7.250	0.750	0.750	2.170	3.000

Code E & E	Thread Diameter x Take-Up in.	Working Load Limit lbs	Weight /ea. lbs	B	F Closed	U2 Closed	W
TEEZ-014218	1/4 x 2 1/8	150	0.17	0.425	4.750	0.970	2.375
TEEZ-516258	5/16 x 2 5/8	225	0.25	0.380	6.375	1.580	2.625
TEEZ-038003	3/8 x 3	300	0.41	0.500	7.125	1.800	3.000

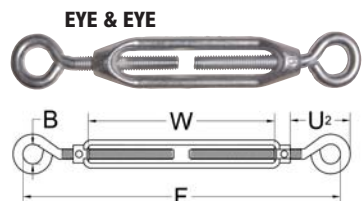
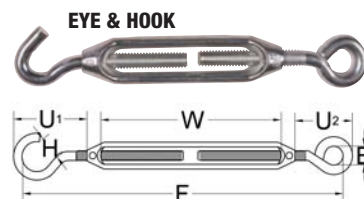



## Bolt Type Anchor Shackles, rated (drop forged, galvanized)

Code	Size in.	Working Load Limit Ton	Weight / ea. lbs	Dimensions in.								
				A		B Min	D Min	G Max	H		L Min	T Max
				Nominal	±				Nominal	±		
SPAS2130G012	1/2	2	0.79	1 7/8	1/8	1 3/16	1/2	23/32	13/16	1/16	5/8	1 3/8
SPAS2130G058	5/8	3 1/4	1.68	2 13/32	1/8	1 1/2	5/8	27/32	1 1/16	1/16	3/4	1 7/8
SPAS2130G034	3/4	4 3/4	2.72	2 27/32	1/4	1 3/4	3/4	31/32	1 1/4	1/16	7/8	2 1/8
SPAS2130G078	7/8	6 1/2	3.95	3 5/16	1/4	2	7/8	1 3/32	1 7/16	1/16	1	2 3/8
SPAS2130G001	1	8 1/2	6.12	3 3/4	1/4	2 5/16	1	1 7/32	1 11/16	1/16	1 1/8	2 5/8
SPAS2130G118	1 1/8	9 1/2	8.27	4 1/4	1/4	2 5/8	1 1/8	1 11/32	1 13/16	1/16	1 1/4	2 7/8
SPAS2130G114	1 1/4	12	11.71	4 11/16	1/4	2 7/8	1 1/4	1 15/32	2 1/32	1/16	1 3/8	3 1/4
SPAS2130G138	1 3/8	13 1/2	15.38	5 1/4	1/4	3 1/4	1 3/8	1 5/8	2 1/4	1/8	1 1/2	3 1/2
SPAS2130G112	1 1/2	17	20.80	5 3/4	1/4	3 3/8	1 1/2	1 3/4	2 3/8	1/8	1 5/8	3 3/4
SPAS2130G134	1 3/4	25	33.91	7	1/4	4 1/2	1 3/4	2 5/32	2 7/8	1/8	2	4 1/2
SPAS2130G002	2	35	52.25	7 3/4	1/2	5 1/4	2	2 13/32	3 1/4	1/8	2 1/4	5 1/4

Safety Factor 6:1

Federal Specification : RR-C-271D *Other dimensions available upon request.*

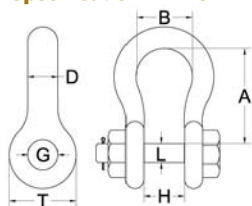

## Screw Pin Anchor Shackles, rated (drop forged, galvanized)

Code	Size in.	Working Load Limit Ton	Weight / ea. lbs.	Dimensions in.								
				A		B Min	D Min	G Max	H		L Min	T Max
				Nominal	±				Nominal	±		
SPASX-316	3/16	1/3	0.06	7/8	1/16	9/16	3/16	5/16	3/8	1/16	1/4	5/8
SPASX-014	1/4	1/2	0.10	1 1/8	1/16	3/4	1/4	13/32	15/32	1/16	5/16	7/8
SPASX-516	5/16	3/4	0.19	1 1/4	1/16	13/16	5/16	15/32	17/32	1/16	3/8	1
SPASX-038	3/8	1	0.31	1 7/16	1/8	15/16	3/8	17/32	21/32	1/16	7/16	1 1/8
SPASX-716	7/16	1 1/2	0.38	1 11/16	1/8	1 1/16	7/16	19/32	23/32	1/16	1/2	1 1/4
SPASX-012	1/2	2	0.72	1 7/8	1/8	1 3/16	1/2	23/32	13/16	1/16	5/8	1 3/8
SPASX-058	5/8	3 1/4	1.37	2 13/32	1/8	1 1/2	5/8	27/32	1 1/16	1/16	3/4	1 7/8
SPASX-034	3/4	4 3/4	2.35	2 27/32	1/4	1 3/4	3/4	31/32	1 1/4	1/16	7/8	2 1/8
SPASX-078	7/8	6 1/2	3.62	3 5/16	1/4	2	7/8	1 3/32	1 7/16	1/16	1	2 3/8
SPASX-001	1	8 1/2	5.00	3 3/4	1/4	2 5/16	1	1 7/32	1 11/16	1/16	1 1/8	2 5/8
SPASX-118	1 1/8	9 1/2	7.41	4 1/4	1/4	2 5/8	1 1/8	1 11/32	1 13/16	1/16	1 1/4	2 7/8
SPASX-114	1 1/4	12	9.50	4 11/16	1/4	2 7/8	1 1/4	1 15/32	2 1/32	1/16	1 3/8	3 1/4
SPASX-138	1 3/8	13 1/2	13.53	5 1/4	1/4	3 1/4	1 3/8	1 5/8	2 1/4	1/8	1 1/2	3 1/2
SPASX-112	1 1/2	17	17.20	5 3/4	1/4	3 3/8	1 1/2	1 3/4	2 3/8	1/8	1 5/8	3 3/4
SPASX-134	1 3/4	25	27.78	7	1/4	4 1/2	1 3/4	2 5/32	2 7/8	1/8	2	4 1/2
SPASX-002	2	35	45.0	7 3/4	1/2	5 1/4	2	2 13/32	3 1/4	1/8	2 1/4	5 1/4
SPASX-212	2 1/2	55	85.0	10 1/2	1/2	6 3/4	2 1/2	2 29/32	4 1/8	1/8	2 3/4	6 1/4

Safety Factor 6:1

Federal Specification : RR-C-271D *Other dimensions available upon request.*

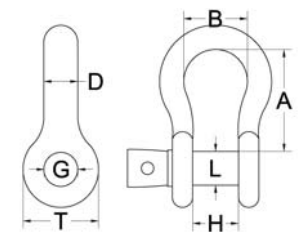



### Snatch Block with Swivel Hook

Code	For cable diameter in.	Pulley Diameter in.	Working Load Limit Ton	Weight ea. lbs
K4180-002	3/8	3	2	2
K4180-004	1/2	4 1/2	4	12



### Snatch Block with Shackle

Code	For cable diameter in.	Pulley Diameter in.	Working Load Limit Ton	Weight ea. lbs
K4190-002	3/8	3	2	2
K4190-004	1/2	4 1/2	4	10



### Toggle Block (Tail Board)

Code	For cable diameter in.	Pulley Diameter in.	Working Load Limit Ton	Weight ea. lbs
K4040-002	3/8	3	2	2
K4040-004	1/2	4 1/2	4	7.5



### Screw Pin Anchor Shackles, non-rated (drop forged, galvanized)

Code	Size in.	Working Load Limit Ton	Weight / ea. lbs.	Dimensions in.						
				A	B	D	G	H	L	T
SPAS-316	3/16	1/4	0.06	13/16	5/8	3/16	.260	.400	1/4	1/2
SPAS-014	1/4	1/3	0.10	1	3/4	1/4	.350	.500	5/16	9/16
SPAS-516	5/16	1/2	0.19	1 3/16	13/16	5/16	.425	.525	3/8	11/64
SPAS-038	3/8	3/4	0.31	1 3/8	1	3/8	.500	.675	7/16	13/16
SPAS-716	7/16	1	0.38	1 5/8	1 1/8	7/16	.550	.750	1/2	15/16
SPAS-012	1/2	1 1/2	0.72	1 7/8	1 1/4	1/2	.660	.775	5/8	1 1/16
SPAS-058	5/8	2 1/4	1.37	2 3/8	1 11/16	5/8	.610	1.000	3/4	1 3/8
SPAS-034	3/4	3 1/4	2.35	2 5/8	2	3/4	.975	1.250	7/8	1 1/2
SPAS-078	7/8	4 1/3	3.62	3	2 1/4	7/8	1.000	1.500	1	1 7/8
SPAS-001	1	5 1/2	5.00	4	2 5/8	1	1.200	1.675	1 1/8	2 1/4

Safety Factor 5:1

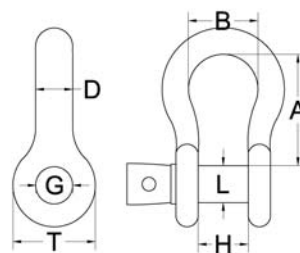

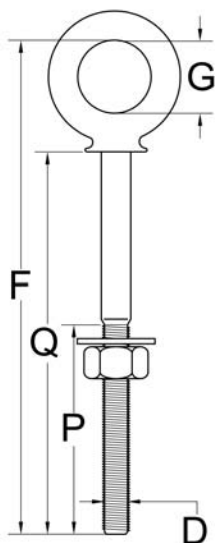

### Shoulder Nut Eye Bolts (galvanized, drop-forged)

Code	Working Load Limit lbs.	Weight / ea. lbs.	Dimensions in.				
			D	F	G	P	Q
SNEB-014002	500	0.07	1/4	2 3/4	1/2	1 1/2	2
SNEB-014004	500	0.09	1/4	4 3/4	1/2	2 1/2	4
SNEB-516214	800	0.12	5/16	3 1/4	5/8	1 1/2	2 1/4
SNEB-516414	800	0.19	5/16	5 1/4	5/8	2 1/2	4 1/4
SNEB-038212	1,200	0.22	3/8	3 5/8	3/4	1 1/2	2 1/2
SNEB-038412	1,200	0.25	3/8	5 5/8	3/4	2 1/2	4 1/2
SNEB-012314	2,200	0.43	1/2	3 3/4	3/4	1 1/2	3 1/4
SNEB-012006	2,200	0.56	1/2	7 1/2	1	3	6
SNEB-058004	3,500	0.70	5/8	5 7/8	1 1/4	2	4
SNEB-058006	3,500	1.00	5/8	7 7/8	1 1/4	3	6
SNEB-034412	5,200	1.44	3/4	6 3/4	1 1/2	2	4 1/2
SNEB-034006	5,200	1.70	3/4	8 1/4	1 1/2	3	6
SNEB-078005	7,200	2.25	7/8	7 3/4	1 3/4	2 1/2	5
SNEB-001006	10,000	3.67	1	9	2	3	6
SNEB-001009	10,000	4.23	1	12	2	4	9
SNEB-114008	15,200	6.50	1	11 3/4	2 1/2	4	8
SNEB-114012	15,200	7.95	1 1/4	15 3/4	2 1/2	4	12
SNEB-112015	21,400	14.25	1 1/2	19 1/2	3	6	15

Safety Factor 5:1

N.B. : UNC Thread

### Shoulder Type Machinery Eye Bolts (zinc plated drop-forged)

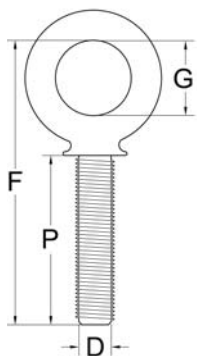

Code	Working Load Limit lbs.	Weight / ea. lbs.	Dimensions in.			
			D	F	G	P
STEB-014001	500	0.05	1/4	2 1/8	3/4	1
STEB-516118	900	0.10	5/16	2 1/2	7/8	1 1/8
STEB-038114	1,300	0.16	3/8	2 15/16	1	1 1/4
STEB-012112	2,400	0.35	1/2	3 1/4	1 1/8	1 1/2
STEB-058134	4,000	0.67	5/8	4 1/8	1 1/4	1 3/4
STEB-034002	5,000	1.00	3/4	4 3/8	1 1/2	2
STEB-078214	7,000	1.63	7/8	5 1/8	1 3/4	2 1/4
STEB-001212	9,000	2.22	1	5 7/8	2	2 1/2
STEB-114003	15,000	4.44	1 1/4	6 7/8	2 1/2	3
STEB-112312	21,000	7.36	1 1/2	9 1/8	3	3 1/2

Safety Factor 5:1

N.B. : UNC Thread



## Regular Nut Eye Bolts (galvanized, drop-forged)

Code	Working Load Limit lbs.	Weight / ea. lbs.	Dimensions in.				
			D	F	G	P	Q
RNEB-014002	500	0.08	1/4	2 3/4	1/2	1 1/2	2
RNEB-014004	500	0.12	1/4	4 3/4	1/2	2 1/2	4
RNEB-516214	800	0.13	5/16	3 1/4	5/8	1 1/2	2 1/4
RNEB-516414	800	0.25	5/16	5 1/4	5/8	2 1/2	4 1/4
RNEB-038212	1,200	0.24	3/8	3 3/4	3/4	1 1/2	2 1/2
RNEB-038412	1,200	0.29	3/8	5 3/4	3/4	2 1/2	4 1/2
RNEB-038006	1,200	0.35	3/8	7 1/4	3/4	2 1/2	6
RNEB-012314	2,200	0.50	1/2	4 7/8	1	1 1/2	3 1/4
RNEB-012006	2,200	0.66	1/2	7 5/8	1	3	6
RNEB-012008	2,200	0.82	1/2	9 5/8	1	3	8
RNEB-012010	2,200	0.88	1/2	11 5/8	1	3	10
RNEB-012012	2,200	1.15	1/2	13 5/8	1	3	12
RNEB-058004	3,500	1.03	5/8	6	1 1/4	2	4
RNEB-058006	3,500	1.20	5/8	8	1 1/4	3	6
RNEB-058008	3,500	1.35	5/8	10	1 1/4	3	8
RNEB-058010	3,500	1.53	5/8	12	1 1/4	3	10
RNEB-058012	3,500	1.67	5/8	14	1 1/4	4	12
RNEB-034412	5,200	1.68	3/4	7	1 1/2	2	4 1/2
RNEB-034006	5,200	1.85	3/4	8 1/2	1 1/2	3	6
RNEB-034008	5,200	2.08	3/4	10 1/2	1 1/2	3	8
RNEB-034010	5,200	2.37	3/4	12 1/2	1 1/2	3	10
RNEB-034012	5,200	2.58	3/4	14 1/2	1 1/2	4	12
RNEB-034015	5,200	3.00	3/4	17 1/2	1 1/2	5	15
RNEB-078005	7,200	2.70	7/8	7 7/8	1 3/4	2 1/2	5
RNEB-078008	7,200	3.10	7/8	10 7/8	1 3/4	4	8
RNEB-078012	7,200	4.00	7/8	14 7/8	1 3/4	4	12
RNEB-001006	10,000	4.25	1	9 1/4	2	3	6
RNEB-001009	10,000	4.70	1	12 1/4	2	4	9
RNEB-001012	10,000	5.40	1	15 1/4	2	4	12
RNEB-001018	10,000	6.50	1	21 1/4	2	7	18
RNEB-114008	15,200	7.50	1 1/4	12 1/8	2 1/2	4	8
RNEB-114012	15,200	9.00	1 1/4	16 1/8	2 1/2	4	12
RNEB-114020	15,200	12.1	1 1/4	24 1/8	2 1/2	6	20

Safety Factor 5:1

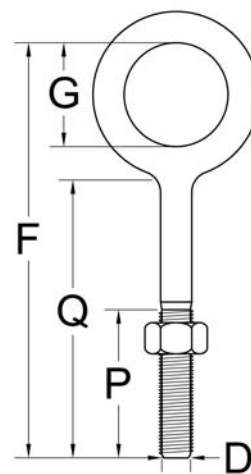

N.B. : UNC Thread

## Eye Nuts (galvanized, drop-forged)

Code	Tap Size in.	Working Load Limit lbs.	Weight / ea. lbs.	Dimensions in.			
				A	B	D	E
EN-014	1/4 - 20	520	0.09	0.690	0.750	0.250	1.690
EN-516	5/16 - 18	700	0.11	0.690	0.750	0.250	1.690
EN-038	3/8 - 16	1,250	0.18	1.250	1.000	0.312	2.062
EN-012	1/2 - 13	2,250	0.28	1.500	1.250	0.375	2.500
EN-058	5/8 - 11	3,600	0.58	2.000	1.500	0.500	3.187
EN-034	3/4 - 10	5,200	1.00	2.375	1.750	0.625	3.875
EN-078	7/8 - 9	7,200	1.70	2.625	2.000	0.750	4.312
EN-001	1	10,000	2.75	3.065	2.155	0.910	5.050

Safety Factor 5:1

Also available in stainless steel. Other dimensions available upon request.

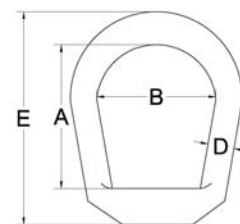

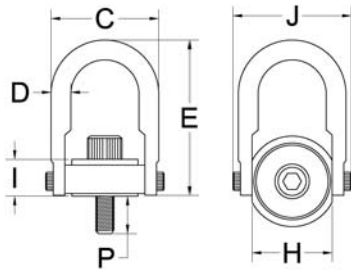

### UNC Swivel Hoist Rings

Code	Min. Load lbs	Thread	Dimensions (in.)							Torque ft/lbs	Poids lbs
			C	D	E	H	I	J	P		
SHR-516332	800	5/16-13	1 5/8	3/8	2 5/8	1	45/64	1 27/32	3/32	7	0.3
SHR-5161732	800	5/16-18	1 5/8	3/8	2 5/8	1	45/64	1 27/32	17/32	7	0.3
SHR-0381732	1,000	3/8-16	1 5/8	3/8	2 5/8	1	45/64	1 27/32	17/32	12	0.3
SHR-0121116	2,500	1/2-13	2 7/16	1/2	3 3/4	1 13/32	56/64	2 9/16	1 1/16	26	1.0
SHR-012034	2,500	1/2-13	3 1/4	3/4	4 3/4	2	1 7/32	3 1/2	3/4	26	2.6
SHR-012001	2,500	1/2-13	3 1/4	3/4	4 3/4	2	1 7/32	3 1/2	1	28	2.6
SHR-012114	2,500	1/2-13	3 1/4	3/4	4 3/4	2	1 7/32	3 1/2	1 1/4	28	2.6
SHR-058034	4,000	5/8-11	3 1/4	3/4	4 3/4	2	1 7/32	3 1/2	3/4	60	2.6
SHR-058001	4,000	5/8-11	3 1/4	3/4	4 3/4	2	1 7/32	3 1/2	1	60	2.6
SHR-058114	4,000	5/8-11	3 1/4	3/4	4 3/4	2	1 7/32	3 1/2	1 1/4	60	2.6
SHR-034001a	5,000	3/4-10	3 1/4	3/4	4 3/4	2	1 7/32	3 1/2	1	100	3.0
SHR-034112a	5,000	3/4-10	3 1/4	3/4	4 3/4	2	1 7/32	3 1/2	1 1/2	100	3.0
SHR-034001b	7,000	3/4-10	4 13/16	1	6 1/2	3	1 11/16	5 9/16	1	100	7.0
SHR-034112b	7,000	3/4-10	4 13/16	1	6 1/2	3	1 11/16	5 9/16	1 1/2	100	7.0
SHR-078001	8,000	7/8-9	4 13/16	1	6 1/2	3	1 11/16	5 9/16	1	160	7.0
SHR-001114	10,000	1-8	4 13/16	1	6 1/2	3	1 11/16	5 9/16	1 1/4	230	7.5
SHR-001112	10,000	1-8	4 13/16	1	6 1/2	3	1 11/16	5 9/16	1 1/2	230	7.5
SHR-001214	10,000	1-8	4 13/16	1	6 1/2	3	1 11/16	5 9/16	2 1/4	230	7.5
SHR-114002	15,000	1 1/4-7	5	1 1/4	8 3/4	3 3/4	2 7/64	6 1/2	2	470	14.0
SHR-112234	24,000	1 1/2-6	8	1 3/4	12 15/32	4 7/8	2 13/16	8 35/64	2 3/4	800	34.0
SHR-002003	30,000	2 1/2-4	8	1 3/4	12 15/32	4 7/8	2 13/16	8 35/64	3	800	36.0
SHR-212004	50,000	2 1/2-4	10 1/2	2 1/4	18 7/8	6 1/2	4 3/32	11 43/64	4	2,100	88.0
SHR-003514	75,000	3-4	13	2 3/4	19 1/2	8 7/64	5 17/64	14 5/32	5 1/4	4,300	166.0
SHR-312007	100,000	3 1/2-4	14	3 1/4	22 3/32	8 7/64	6 1/16	15 29/32	7	5,100	265.0

Safety Factor 6:1

### Metric Swivel Hoist Rings

Code	Min. Load kg	Thread	Dimensions (mm)							Torque kg-m	Poids kg
			C	D	E	H	I	J	P		
SHR-M08013	400	M8x1.25	41	10	68	25	18	47	13	0.88	0.17
SHR-M10018	500	M10x1.50	41	10	68	25	18	47	18	1.5	0.17
SHR-M12019	1,050	M12x1.75	83	19	121	51	30	89	19	3.7	1.06
SHR-M16029	1,900	M16x2.00	83	19	121	51	30	89	29	8.4	1.12
SHR-M20034	2,150	M20x2.50	83	19	121	51	30	89	34	14	1.19
SHR-M20032	3,000	M20x2.50	122	25	166	76	43	131	32	14	3.03
SHR-M24037	4,200	M24x3.00	122	25	166	76	43	131	37	31	3.10
SHR-M30042	7,000	M30x3.50	152	32	222	95	54	165	42	60	5.30
SHR-M30062	7,000	M30x3.50	152	32	222	95	54	165	62	60	6.40
SHR-M36064	11,000	M36x4.00	203	44	317	124	71	217	64	100	16.60
SHR-M42082	12,500	M42x4.50	203	44	317	124	71	217	82	100	16.80
SHR-M48082	13,500	M48x5.00	203	44	317	124	71	217	82	100	16.80
SHR-M64101	22,300	M64x6.00	266	57	428	165	103	296	101	273	39.0
SHR-M72132	31,500	M72x6.00	330	70	495	206	133	359	132	559	74.0
SHR-M90177	44,500	M90x6.00	368	83	561	218	153	404	177	663	118.0

Safety Factor 6:1



### Eye Hooks with latch (alloy, zinc plated)

Code	Working Load Limit Ton	Weight / ea. lbs.	Dimensions in.				
			C	D	F	G	H
EH-034	3/4	0.54	2.54	.33	2.80	.63	.81
EH-001	1	0.61	2.83	.36	3.34	.75	.89
EH-112	1 1/2	0.89	3.11	.42	3.81	.91	.91
EH-002	2	1.44	3.53	.55	4.14	1.13	1.00
EH-003	3	2.07	3.97	.58	4.69	1.25	1.09
EH-412	4 1/2	4.30	4.81	.72	5.77	1.56	1.36
EH-007	7	8.30	6.27	.90	7.37	2.00	1.61
EH-011	11	15.00	7.45	1.11	9.07	2.44	2.08
EH-015	15	21.60	8.30	1.27	10.08	2.84	2.27

Safety Factor 5:1

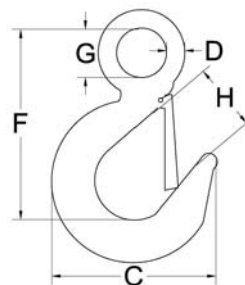

### Eye Hooks with latch (carbon, zinc plated)

Code	Working Load Limit Ton	Weight / ea. lbs.	Dimensions in.				
			C	D	F	G	H
EH-034C	3/4	.61	2.83	.36	3.34	.75	.89
EH-001C	1	.89	3.11	.42	3.81	.91	.91
EH-112C	1 1/2	1.44	3.53	.55	4.14	1.13	1.00
EH-002C	2	2.07	3.97	.58	4.69	1.25	1.09
EH-003C	3	4.30	4.81	.72	5.77	1.56	1.36
EH-412C	4 1/2	8.30	6.27	.90	7.37	2.00	1.61
EH-007C	7	15.00	7.45	1.11	9.07	2.44	2.08
EH-010C	10	20.77	8.30	1.27	10.08	2.84	2.27
EH-015C	15	39.50	10.30	1.56	12.53	3.50	3.02

Safety Factor 5:1

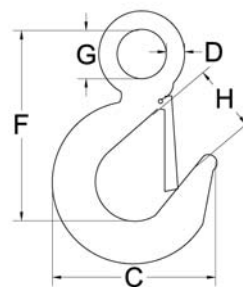

### Swivel Hooks with latch (alloy, zinc plated)

Code	Working Load Limit Ton	Weight / ea. lbs.	Dimensions in.				
			B	C	D	F	H
SH-001	1	0.75	1.25	2.86	.38	4.55	.89
SH-112	1 1/2	1.25	1.50	3.15	.50	5.37	.91
SH-002	2	2.25	1.75	3.59	.63	6.12	1.00
SH-003	3	2.30	1.75	4.00	.63	6.50	1.09
SH-412	4 1/2	4.96	2.00	4.84	.75	7.50	1.36
SH-007	7	10.29	2.50	6.28	1.00	9.63	1.61
SH-011	11	16.18	2.75	7.54	1.13	11.37	2.08
SH-015	15	23.25	3.12	8.34	1.25	12.25	2.27

Safety Factor 5:1

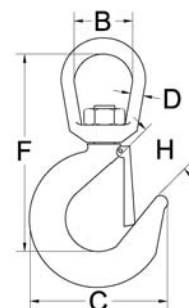

### Swivel Hooks with latch (carbon, zinc plated)

Code	Working Load Limit lbs.	Weight / ea. lbs.	Dimensions in.				
			B	C	D	F	H
SH-034C	3/4	.75	1.25	2.86	.38	4.55	.89
SH-001C	1	1.25	1.50	3.15	.50	5.37	.91
SH-112C	1 1/2	2.25	1.75	3.59	.63	6.12	1.00
SH-002C	2	2.30	1.75	4.00	.63	6.50	1.09
SH-003C	3	4.96	2.00	4.84	.75	7.50	1.36
SH-005C	5	10.29	2.50	6.28	1.00	9.63	1.61

Safety Factor 5:1

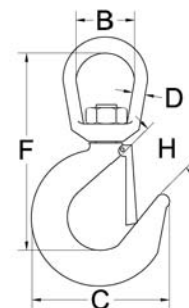

### Safety Latch Kits (stainless steel)

Code	For hooks with capacity Carbon & alloy Ton.	Weight / ea. lbs.
SS4055-012	1/2 & 3/4	0.01
SS4055-034	3/4 & 1	0.02
SS4055-001	1 & 1 1/2	0.02
SS4055-112	1 1/2 & 2	0.03
SS4055-002	2 & 3	0.03

Code	For hooks with capacity Carbon & alloy Ton.	Weight / ea. lbs.
SS4055-003	3 & 4 1/2	0.06
SS4055-005	5 & 7	0.11
SS4055-712	7 1/2 & 11	0.17
SS4055-010	10 & 15	0.17





### Sorting Hooks (alloy)

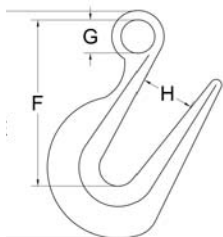

Code	Working Load Limit at bottom Ton	Working Load Limit at tip of hook Ton	Style	Weight / ea. lbs.	Dimensions in.			
					E	F	G	H
A378-002	7 1/2	2	No handle	6.42	9.69	9 3/16	1.38	2.81

Safety Factor 4:1

### Eye Slip Tow and Land Yard Hooks (zinc plated steel)



BM-5316

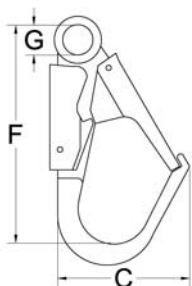

BM-5315

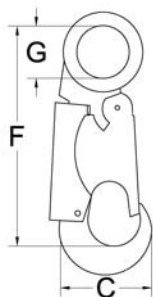

BM-5555

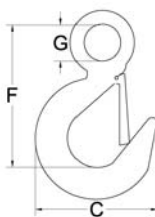

BM-BC53

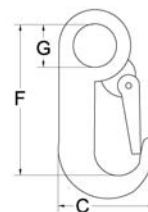

Code	Inside Eye Diameter In.	Throat opening In.	Working Load Limit lbs.	Weight / ea. lbs.	Dimensions in.		
					C	F	G
BM-BC53	3/4	1/2	800	0.33	1.771	2.553	0.75
BM-5555	3/4	5/8	1,500	0.45	2.172	2.827	0.75
BM-5315	1	5/8	1,000	0.61	2.321	4.435	1.00
BM-5316	1	1 3/4	1,000	0.89	3.919	7.000	1.00

Safety Factor 5:1

### Eye Grab Hooks (Gr. 40 zinc plated)

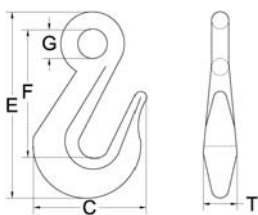

Code	For Chain Diameter in.	Working Load Limit lbs.	Weight / ea. lbs.	Dimensions in.				
				C	E	F	G	T
EGH40-014	1/4	2,600	0.28	1.81	3.05	1.88	.53	.47
EGH40-516	5/16	3,900	0.45	2.12	3.59	2.28	.62	.59
EGH40-038	3/8	5,400	0.79	2.53	4.28	2.69	.75	.72

Safety Factor 4:1

### Clevis Grab Hooks (Gr. 40, Zinc Plated)

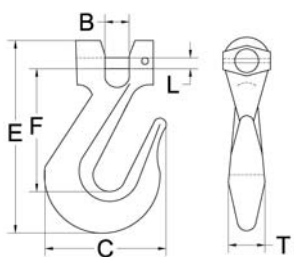

Code	For Chain Diameter in.	Working Load Limit lbs.	Weight / ea. lbs.	Dimensions in.					
				B	C	E	F	L	T
CGH40-014	1/4	2,600	0.38	.32	1.81	3.05	1.64	.31	.47
CGH40-516	5/16	3,900	0.70	.43	2.12	3.66	2.02	.38	.59
CGH40-038	3/8	5,400	1.04	.48	2.53	4.42	2.41	.44	.72
CGH40-716	7/16	7,200	1.31	.66	3.09	4.94	2.75	.56	.69
CGH40-012	1/2	9,200	2.06	.57	3.56	5.72	3.19	.63	.78

Safety Factor 4:1



### Eye Slip Hooks (Gr. 40 zinc plated)

Code	For Chain Diameter in.	Working Load Limit lbs.	Weight / ea. lbs.	Dimensions in.				
				C	F	G	H	T
ESH40-014	1/4	1,950	0.40	2.75	2.56	.50	.94	.50
ESH40-516	5/16	2,875	0.70	3.06	2.95	.63	1.06	.56
ESH40-038	3/8	4,000	1.00	3.63	3.36	.72	1.31	.66
ESH40-012	1/2	6,900	2.00	4.81	4.28	.94	1.69	.91

Safety Factor 4:1

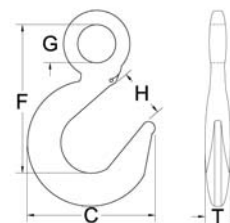

### Clevis Slip Hooks (Gr. 40, zinc plated)

Code	For Chain Diameter in.	Working Load Limit lbs.	Weight / ea. lbs.	Dimensions in.						
				B	C	E	F	H	L	T
CSH40-014	1/4	1,950	0.50	.32	2.75	3.95	2.58	.94	.38	.50
CSH40-516	5/16	2,875	0.75	.43	3.06	4.52	2.87	1.06	.44	.56
CSH40-038	3/8	4,000	1.13	.45	3.63	5.15	3.25	1.31	.47	.66
CSH40-716	7/16	5,000	2.06	.59	4.34	5.97	3.70	1.56	.56	.81
CSH40-012	1/2	6,000	2.75	.57	4.81	6.53	4.00	1.69	.63	.91

Safety Factor 4:1

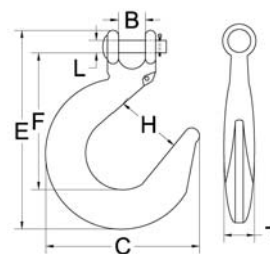

### Clevis Slip Hooks (Gr. 70, gold chromate)

Code without latch	Code with latch	For Chain Diameter in.	Working Load Limit lbs.	Weight / ea. lbs.	Dimensions in.						
					B	C	E	F	H	L	T
CSH70-014	CSH70L-014	1/4	2,750	0.50	.32	2.75	3.95	2.58	.94	.38	.50
CSH70-516	CSH70L-516	5/16	4,300	0.75	.43	3.06	4.52	2.87	1.06	.44	.56
CSH70-038	CSH70L-038	3/8	5,250	1.13	.45	3.63	5.15	3.25	1.31	.47	.66
CSH70-716	CSH70L-716	7/16	7,000	2.06	.59	4.34	5.97	3.70	1.56	.56	.81
CSH70-012	CSH70L-012	1/2	9,000	2.75	.57	4.81	6.53	4.00	1.69	.63	.91

Safety Factor 4:1

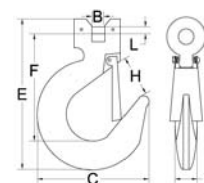

### Clevis Grab Hooks (Gr. 70, gold chromate)

Code	For Chain Diameter in.	Working Load Limit lbs.	Weight / ea. lbs.	Dimensions in.							
				B	C	E	F	H	J	L	T
CGH70-014	1/4	3,150	0.38	.32	1.81	3.05	1.64	.34	.72	.31	.47
CGH70-516	5/16	4,700	0.70	.43	2.12	3.66	2.02	.44	.91	.38	.59
CGH70-038	3/8	6,600	1.04	.48	2.53	4.42	2.41	.50	1.00	.44	.72
CGH70-012	1/2	11,300	2.06	.57	3.56	5.72	3.19	.66	1.25	.63	.78

Safety Factor 4:1

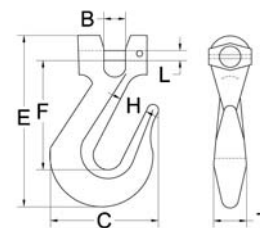

### Clevis Grab Hooks with latch (Gr. 70, gold chromate)

Code	For Chain Diameter in.	Working Load Limit lbs.	Weight / ea. lbs.	Dimensions in.				
				B	F	H	I	L
CGH70L-014	1/4	3,150	0.64	0.354	1.970	0.394	0.394	0.378
CGH70L-516	5/16	4,700	0.96	0.394	2.260	0.433	0.492	0.433
CGH70L-038	3/8	6,600	1.34	0.472	2.630	0.500	0.413	0.472
CGH70L-012	1/2	11,300	2.75	0.752	3.189	0.661	0.701	0.630

Safety Factor 4:1

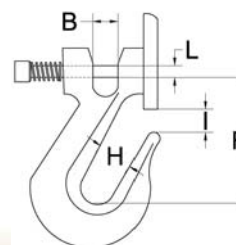

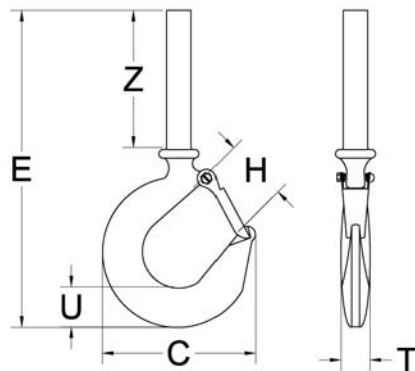

### Shank Hooks, with latch (carbon)

Code	Working Load Limit Ton	Weight / ea. lbs.	Dimensions in.					
			C	E	H	T	U	Z
S319CH-034	3/4	.50	2.86	5.14	.93	.63	.73	2.06
Safety Factor 5:1								

### Open Swage Sockets (forged steel)

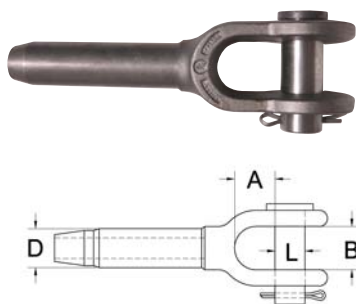

Code	For cable diameter in.	Weight ea. lbs.	Dimensions in.				
			A	B	D Before swage	D After swage	L
S501-014	1/4	0.57	1.156	1 1/16	.495	.438	.688
S501-516	5/16	1.24	1.344	13/16	.770	.688	.812
S501-038	3/8	.120	1.344	13/16	.770	.688	.812
S501-716	7/16	2.45	1.500	1	.982	.875	1.00
S501-012	1/2	2.40	1.500	1	.982	.875	1.00
S501-916	9/16	4.80	1.655	1 1/4	1.26	1.13	1.19
S501-058	5/8	4.50	1.655	1 1/4	1.26	1.13	1.19
S501-034	3/4	7.80	2.150	1 1/2	1.55	1.38	1.38
S501-078	7/8	11.80	2.435	1 3/4	1.70	1.50	1.63
S501-001	1	17.80	2.750	2	1.98	1.75	2.00
S501-118	1 1/8	28.90	3.125	2 1/4	2.25	2.00	2.25
S501-114	1 1/4	36.20	3.500	2 1/2	2.53	2.25	2.50
S501-138	1 3/8	47.70	4.00	2 1/2	2.80	2.50	2.50
S501-112	1 1/2	64.40	4.375	3	3.08	2.75	2.75

## ISO 9001:2000

### Quality at Ben-Mor ...

- A **Quality management system** insuring to our customers the highest level of quality in our services and products;
- Management by **process**;
- Systematic receiving **inspection** and testing of all merchandise to insure that all products are up to the specs in place;
- Periodic **evaluation** of all our suppliers;
- All products managed by a unique and efficient **traceability** system;
- Rigorous **inspections** executed by a team of experts throughout the process;
- All the essential **equipment** for an efficient quality control, including a 225,000 lbs capacity test bench.
- Rigorous **calibration** of all production and control equipment;
- Continuous **training** of our employees;
- A multidisciplinary team offering complete and professional technical **support**;
- The **involvement** of all employees in our quality management system.



### Closed Swage Sockets (forged steel)

Code	For cable diameter in.	Weight ea. lbs.	Dimensions in.				
			C	D Before swage	D After swage	G	T
S502-014	1/4	0.35	1 7/16	.495	.438	.750	1/2
S502-516	5/16	0.77	1 11/16	.770	.688	.875	11/16
S502-038	3/8	0.73	1 11/16	.770	.688	.875	11/16
S502-716	7/16	1.47	2	.982	.875	1.06	7/8
S502-012	1/2	1.38	2	.982	.982	1.06	7/8
S502-916	9/16	2.90	2 1/2	1.26	1.13	1.25	1 1/8
S502-058	5/8	2.80	2 1/2	1.26	1.13	1.25	1 1/8
S502-034	3/4	5.16	3	1.55	1.38	1.44	1 5/16
S502-078	7/8	7.40	3 1/2	1.70	1.50	1.69	1 1/2
S502-001	1	11.20	4	1.98	1.75	2.06	1 3/4
S502-118	1 1/8	16.00	4 1/2	2.25	2.00	2.31	2
S502-114	1 1/4	22.70	5	2.53	2.25	2.56	2 1/4
S502-138	1 3/8	29.00	5 1/4	2.80	2.50	2.56	2 1/4
S502-112	1 1/2	37.50	5 1/2	3.08	2.75	2.81	2 1/2

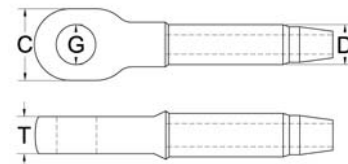

### Open Spelter Sockets (forged steel, galvanized)

Code	For cable diameter in.	(G416 - G417) Wirelock Req. cc	Weight ea. lbs.	Dimensions in.		
				A	B	L
G416-014	1/4	9	0.90	1.219	11/16	11/16
G416-516	5/16	17	1.30	1.344	13/16	13/16
G416-038	3/8	17	1.30	1.344	13/16	13/16
G416-716	7/16	35	2.30	1.000	1	1
G416-012	1/2	35	2.30	1.000	1	1
G416-916	9/16	52	3.90	1.313	1 1/4	1 3/16
G416-058	5/8	52	3.90	1.313	1 1/4	1 3/16
G416-034	3/4	86	6.00	1.625	1 1/2	1 3/8
G416-078	7/8	125	10.00	1.875	1 3/4	1 5/8
G416-001	1	160	15.50	2.000	2	2
G416-118	1 1/8	210	24.00	2.250	2 1/4	2 1/4
G416-114	1 1/4	350	32.00	2.250	2 1/2	2 1/2
G416-138	1 3/8	350	32.00	2.250	2 1/2	2 1/2
G416-112	1 1/2	420	46.00	3.625	3	2 3/4

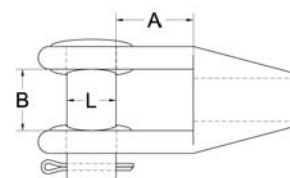

### Closed Spelter Sockets (forged steel, galvanized)

Code	For cable diameter in.	(G417 - G417) Wirelock Req. cc	Weight ea. lbs.	Dimensions in.			
				A	B	C	T
G417-014	1/4	9	0.50	2	1 7/16	0.438	0.50
G417-516	5/16	17	1.00	2	1 11/16	0.563	0.69
G417-038	3/8	17	1.00	2	1 11/16	0.563	0.69
G417-716	7/16	35	1.80	2 1/2	2	0.689	0.88
G417-012	1/2	35	1.80	2 1/2	2	0.689	0.88
G417-916	9/16	52	3.40	3	2 5/8	0.813	1.00
G417-058	5/8	52	3.40	3	2 5/8	0.813	1.00
G417-034	3/4	86	5.10	3 1/2	3	1.063	1.25
G417-078	7/8	125	7.80	4	3 5/8	1.313	1.50
G417-001	1	160	12.00	4 1/2	4 1/8	1.438	1.75
G417-118	1 1/8	210	16.00	5	4 1/2	1.563	2.00
G417-114	1 1/4	350	23.00	5 1/2	5	1.689	2.25
G417-138	1 3/8	350	23.00	5 1/2	5	1.689	2.25
G417-112	1 1/2	420	28.00	6	5 3/8	2.00	2.50

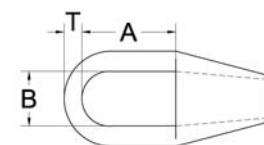



## Ben-Mor Single Shank Balls

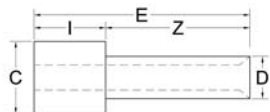

Code	For diameter cable in.	Minimum Breaking Strength lbs.	Material	C	D	E	I	Z
BM20664C3	3/32	500	Zinc	.285	.187	.650	.168	.477
BM20664C4	1/8	800	Zinc	.370	.312	1.004	.266	.735
BM20664C4I	1/8	1,200	Zinc	.400	.269	.700	.208	.483
BM20664C4BAT	1/8	2,000	Zinc plated steel	.375	.252	1.383	.256	1.114
BM20664C6	3/16	3,500	Zinc plated steel	.437	.313	1.444	.997	.435

Plain balls and double shank balls (military specs.) available upon request.

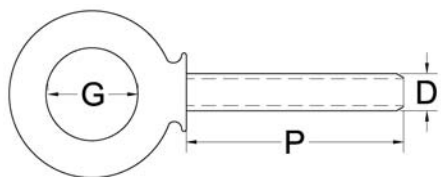

## Eye Bolts shoulder-drilled (zinc plated, drop-forged)

Code	Working Load Limit lbs.	Weight / ea. lbs.	Dimensions in.		
			D	G	P
BM-55830	2400	0.35	1/2	1	1 1/2

Safety Factor 5:1

Other dimensions available upon request  
See Shoulder Type Machinery Eye Bolt for dimensions (page 36)

## Ben-Mor Threaded Studs

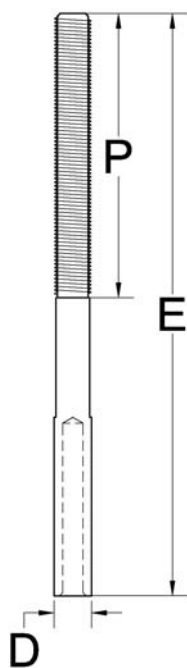

Code	For cable diameter in.	Threads size UNC	Dimensions in.			Finish
			D Before swage	E	P	
BM21259-014f	3/32	1/4 - 20	1/4	2 9/16	1 1/2	ZP
BM21259-014b	1/8	1/4 - 20	1/4	2 1/2	1/2	ZP
BM21259-014c	1/8	1/4 - 20	1/4	2 9/16	1 1/2	ZP
BM21259-014e	1/8	1/4 - 20	1/4	3 3/4	1 1/2	ZP
BM21259-516a	1/8	5/16 - 18	5/16	2 3/4	1 3/4	ZP
BM21259-516b	1/8	5/16 - 18	5/16	4 1/2	3	ZP
BM21259-038a	1/8	3/8 - 16	3/8	3	1 1/2	ZP
BM21259-038b	3/16	3/8 - 16	1/2	3	1 1/2	ZP
BM21259-012a	1/4	1/2 - 13	5/8	4 1/2	2 1/2	ZP
BM21259-058a	5/16	5/8 - 11	3/4	6 1/2	3 1/2	ZP
BM21259-058b	5/16	5/8 - 11	3/4	8	5	ZP
BM21259-058c	3/8	5/8 - 11	7/8	9	6	ZP
BM21259-034a	3/8	3/4 - 10	3/4	8	5	ZP
BM21259-014L	1/8	1/4 - 28	0.250	1.36	3/8	SS
BM21259-038c	1/4	3/8 - 16	0.500	8	5	SS
BM21259-012AB	1/4	1/2 - 13	0.625	6	4	SS
BM21259-012AK	3/8	1/2 - 13	0.700	5.775	1	ZP
BM21259-058AG	5/16	5/8 - 11	0.750	3 1/2	1	SS
BM21259-034X	3/8	3/4 - 10	0.750	13 5/8	5 1/4	Steel
BM21259-034Y	3/8	3/4 - 10	0.750	5 1/8	1 5/8	Steel

Available on request : Stainless steel, Left-Hand thread, metric thread, fine thread. Custom made for cables up to 1 1/2".  
Other dimensions available upon request.



## Stake Hooks

Code	For cable diameter in.	Weight ea. lbs.	Dimensions in.				
			C	D Before swage	D After swage	E	H
BM100-009	1/8	0.220	1 3/16	0.03	0.250	2	0.625

Available in zinc plated steel.

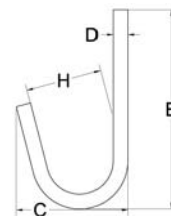

## Ben-Mor Strap Forks

Code	For cable diameter in.	Weight ea. lbs.	Dimensions in.		
			C	E	G
BM-6241	1/16	0.011	0.400	3/4	0.187
BM-6240	1/8	0.117	0.875	2	0.405

Available in steel natural finish and zinc plated.

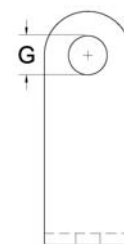
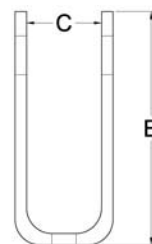

## Ben-Mor Forks

Code	For cable diameter in.	Weight ea. lbs.	Dimensions in.				
			C	D Before swage	D After swage	E	G
BM100-058	3/16	0.2045	3/4	0.501	0.460	2 1/2	0.3125
BM100-031	3/8	0.549	1	0.842	0.775	4 1/2	0.4375
BM100-094	7/16	0.507	1	0.840	0.775	4 1/2	0.4375
BM100-026	3/8	1.069	1	0.840	0.775	7 1/2	0.500

Available in steel natural finish and zinc plated. Custom made for cables up to 1 1/2". Other dimensions available upon request.

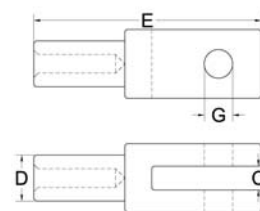

## Ben Mor Eye Ends

Code	For cable diameter in.	Weight ea. lbs.	Dimensions in.				
			C	D Before swage	D After swage	E	G
BM100-028	3/8	0.875	1	0.838	0.775	6 1/4	0.500

Available in steel natural finish and zinc plated. Other dimensions available upon request.

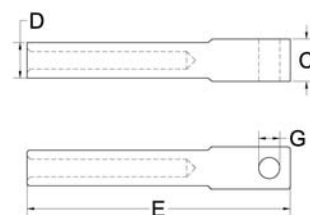



Code : 70823  
 Description : Swivel Lever Snap  
*Zinc, Nickel plated*  
 Dimension Eye : 1"  
 Length : 3 1/2"  
 Std Pack : 6



Code : 70824 (Vrac / Bulk :3142)  
 Description : Heavy Duty Swivel Snap  
*Steel, Nickel plated*  
 Dimension Eye : 1"  
 Length : 3 3/4"  
 Std Pack : 6



Code : 70825  
 Description : Spring Snap (square eye)  
*Zinc, Nickel plated*  
 Dimension Eye : 1"  
 Length : 3"  
 Std Pack : 6



Code : 70827  
 Description : Panic Snap  
*Zinc, Nickel plated*  
 Dimension Eye : 1/2"  
 Length : 3 3/4"  
 Std Pack : 6



Code : 70828 (Bulk : S5-3)  
 Description : Swivel Lock Snap  
*Zinc, Nickel plated*  
 Dimension Eye : 3/4"  
 Length : 3 1/2"  
 Std Pack : 12



Code : 70829 (Bulk : S5-3MNP)  
 Description : Swivel Lock Snap  
*Zinc, Nickel plated*  
 Dimension Eye : 1/2"  
 Length : 3"  
 Std Pack : 12



Code : 70830  
 Description : Swivel Lever Snap  
*Brass*  
 Dimension Eye : 3/4"  
 Length : 3 3/4"  
 Std Pack : 6



Code : 70831  
 Description : Simplex Snap  
*Zinc, Nickel plated*  
 Dimension Eye : -  
 Length : 3 1/4"  
 Std Pack : 6



Code : 70832 (Bulk : S5-1)  
 Description : Swivel Lock Snap  
*Zinc, Nickel plated*  
 Dimension Eye : 3/8"  
 Length : 2"  
 Std Pack : 6



Code : 70810  
 Description : Spring Snap (Zc)  
*Zinc, Nickel plated*  
 Dimension Eye : 3/8"  
 Length : 1 3/4"  
 Std pack : 12



Code : 70812  
 Description : Swivel Spring Snap  
*Zinc, Nickel plated*  
 Dimension Eye : 3/8"  
 Length : 2 1/4"  
 Std Pack : 12



Code : 70813  
 Description : Opened Swivel Snap  
*Zinc, Nickel plated*  
 Dimension Eye : 3/8"  
 Length : 2 1/4"  
 Std Pack : 12



Code : 70816  
 Description : Swivel Lever Snap  
*Zinc, Nickel plated*  
 Dimension Eye : 5/8"  
 Length : 3 1/4"  
 Std Pack : 12



Code : 70819  
 Description : Scissor Snap  
*Zinc, Nickel plated*  
 Dimension Eye : 5/8"  
 Length : 2 1/2"  
 Std Pack : 12



Code : 70820  
 Description : Swivel Lock Snap  
*Brass*  
 Dimension Eye : 3/4"  
 Length : 3"  
 Std Pack : 6



Code : 70821  
 Description : Swivel Lever Snap (br)  
 Dimension Eye : 5/8"  
 Length : 3 1/4"  
 Std Pack : 6



Code : 70822  
 Description : Double Lock Snap  
*Zinc, Nickel plated*  
 Dimension Eye : –  
 Length : 4"  
 Std Pack : 6

### Ben-Mor Snap Hook



Code	Length in.	Breaking Strength lbs.	For cable diameter in.	Weight ea. lbs.
BM844-A-NP	2 1/2	500	3/32	0.082
BM844-B-NP	2 1/8	500	1/8	0.079
BM830-2-NP	2 3/4	1,000	1/8	0.192

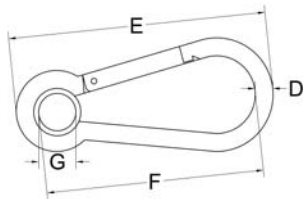

### Carbine Snap Hooks with Eyelets (zinc plated)

Code	Working Load Limit Lbs	Weight / ea. lbs	Dimensions in.				
			D		E	F	G
			in.	mm			
S8-1	100	0.04	3/16	5	1.97	1.586	0.197
S8-2	140	0.06	1/4	6	2.36	1.894	0.197
S8-3	240	0.15	5/16	8	3.15	2.449	0.315
S8-4	400	0.32	3/8	10	3.94	3.071	0.394
S8-5	560	0.60	1/2	12	5.51	4.470	0.512

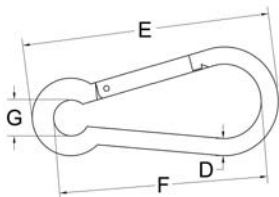

### Carbine Snap Hooks (zinc plated)

Code	Working Load Limit Lbs	Weight / ea. lbs	Dimensions in.				
			D		E	F	G
			in.	mm			
S10-1	100	0.04	3/16	5	1.97	1.614	0.197
S10-2	140	0.06	1/4	6	2.36	1.949	0.197
S10-3	240	0.15	5/16	8	3.15	2.545	0.315
S10-4	400	0.32	3/8	10	3.94	3.199	0.394
S10-4.5	485	0.42	7/16	11	4.72	3.960	0.433
S10-5	560	0.60	1/2	12	5.51	4.606	0.512

Safety Factor 5:1

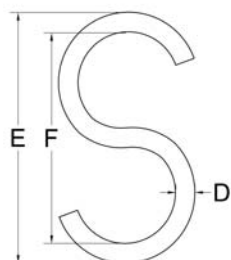

### "S" Hooks (zinc plated)

Code	Weight / ea. lbs	Dimensions in.		
		F	D	
			in.	mm
SHZ-018	0.01	1.30	1/8	3
SHZ-532	0.02	1.50	5/32	4
SHZ-316	0.03	1.44	3/16	5
SHZ-014	0.07	1.75	1/4	6
SHZ-516	0.15	2.34	5/16	8
SHZ-038	0.27	2.40	3/8	10

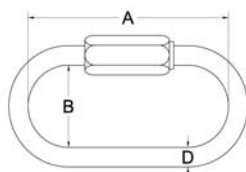

### Quick links rated (zinc plated)

Code Zinc	Working Load Limit Lbs	Weight / ea. lbs	Dimensions in.			
			A	B	D	
					in.	mm
QLZ-018	220	0.03	1.00	0.335	1/8	3
QLZ-316	660	0.06	1.40	0.512	3/16	5
QLZ-014	880	0.09	1.77	0.571	1/4	6
QLZ-516	1,760	0.18	2.28	0.689	5/16	8
QLZ-038	2,640	0.28	2.72	0.808	3/8	10
QLZ-716	2,900	0.48	3.00	0.870	7/16	11
QLZ-012	3,300	0.70	3.17	0.925	1/2	12
QLZ-058	6,000	1.16	4.12	1.065	5/8	16

Safety Factor 2.5 : 1



### Round Rings (Nickel plated)

Code	Std Pack	Dimensions in.	
		A	D
71000	12	1	3/16
71001	12	1 1/4	3/16
71002	12	1 1/2	1/4
71003	12	2	1/4

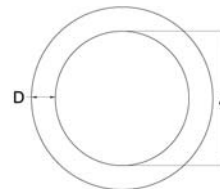

### Zinc Swivel Eye Pulleys (single)

Code	Size in.	Std Pack	Dimensions in.		
			E	H	M
70720	1/2	6	1.775	.460	.225
70721	3/4	6	1.880	.460	.182
70722	1	6	2.340	.460	.295
70723	1 1/4	6	3.365	.810	.400
70724	1 1/2	6	3.480	.820	.384
70725	2	6	4.220	.728	.383

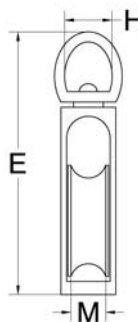

### Zinc Swivel Eye Pulleys (double)

Code	Size in.	Std Pack	Dimensions in.		
			E	H	M
70730	1/2	6	1.78	.460	.200
70731	3/4	6	1.89	.455	.194
70732	1	6	2.36	.445	.290
70733	1 1/4	6	3.36	.815	.400
70734	1 1/2	6	3.50	.818	.405

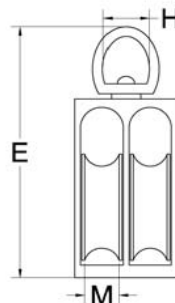

### Zinc Sheave Black Oxide, Ball Bearing

Code	Cable diameter in.	Dimensions in.	
		E	H
BM100063BO	3/16	2	3/8

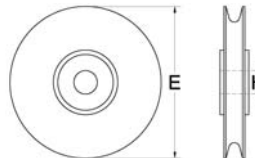

### Black Nylon Fiber Sheave, Ball Bearing

Code	Cable diameter in.	Capacity lbs	Dimensions in.	
			E	H
BM998	3/16	400	3 1/2	3/8
BM999	3/16	250	4 1/2	3/8

