



Accessoires acier inoxydable

Bagues simples (acier inoxydable 304)

SINGLE SLEEVES (STAINLESS STEEL 304)

Code	Dim. câble po.	Poids ch. lbs.
BSS505-516	5/16	0.2
BSS505-038	3/8	0.2
BSS505-716	7/16	0.3
BSS505-012	1/2	0.3
BSS505-058	5/8	0.8
BSS505-034	3/4	1
BSS505-078	7/8	1.5
BSS505-001	1	2.2
BSS505-118	1 1/8	2.8
BSS505-114	1 1/4	2.5
BSS505-138	1 3/8	3.5
BSS505-112	1 1/2	3.8
BSS505-134	1 3/4	7
BSS505-002	2	8



Bagues ovales (acier inoxydable 304)

OVAL SLEEVES (STAINLESS STEEL 304)

Code	Pour câble diamètre po.	Poids / ch. approx. lbs.
SSOS-132	1/32	.001
SSOS-364	3/64	.002
SSOS-116	1/16	.002
SSOS-332	3/32	.003
SSOS-018	1/8	.004
SSOS-532	5/32	.014
SSOS-316	3/16	.023
SSOS-732	7/32	.031
SSOS-014	1/4	.044

Norme fédérale : MS51844 Autres dimensions disponibles sur demande.



Bagues ovales (acier inoxydable 304)

OVAL SLEEVES (STAINLESS STEEL 304)

Code	Pour câble diamètre po.	Poids / ch. approx. lbs.
SSOS-516	5/16	.150
SSOS-038	3/8	.150
SSOS-716	7/16	.350
SSOS-012	1/2	.320
SSOS-058	5/8	.600
SSOS-034	3/4	1.00
SSOS-078	7/8	1.50
SSOS-001	1	2.00

Autres dimensions disponibles sur demande.



Cosses AN (acier inoxydable 304)

AN THIMBLES (STAINLESS STEEL 304)

Code	Pour câble diamètre po.	Poids / ch. approx. lbs.	Dimensions po.		
			A	B	H
ANTS4-116	3/64 – 1/16 – 5/64	.002	43/64	.350	3/32
ANTS4-018	3/32 – 7/64 – 1/8	.004	45/64	.350	9/64
ANTS4-532	5/32	.006	51/64	.400	11/64
ANTS4-316	3/16	.010	1	.500	13/64
ANTS4-014	7/32 – 1/4	.015	1 13/32	.700	17/64
ANTS4-516	9/32 – 5/16	.035	1 51/64	.900	21/64
ANTS4-038	3/8	.085	2	1.000	25/64

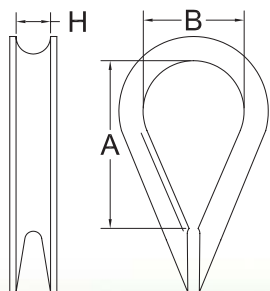



Serre-câbles (acier inoxydable 316) WIRE ROPE CLIPS (STAINLESS STEEL 316)

Code	Pour câble diamètre po.	Dimensions po.		Poids / ch. lbs.
		A	D	
WRCS6-116	1/16	0.620	0.110	0.020
WRCS6-018	1/8	0.810	0.150	0.030
WRCS6-532	5/32	0.810	0.150	0.040
WRCS6-316	3/16	0.960	0.190	0.060
WRCS6-014	1/4	1.490	0.230	0.090
WRCS6-516	5/16	1.315	0.300	0.190
WRCS6-038	3/8	1.855	0.385	0.370
WRCS6-012	1/2	1.965	0.460	0.596
WRCS6-916	9/16	2.630	0.540	0.850
WRCS6-058	5/8	2.630	0.540	1.000
WRCS6-034	3/4	2.730	0.540	1.500
WRCS6-078	7/8	3.000	0.770	2.000
WRCS6-001	I	3.560	0.770	2.500

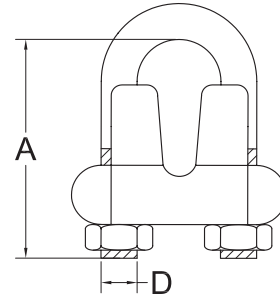

Serre-câbles (acier inoxydable 304) WIRE ROPE CLIPS (STAINLESS STEEL 304)

Code	Pour câble diamètre po.	Dimensions po.		Poids / ch. lbs.
		A	D	
WRCS4-116	1/16	0.705	0.150	0.020
WRCS4-018	1/8	0.830	0.195	0.030
WRCS4-532	5/32	0.905	0.205	0.040
WRCS4-316	3/16	0.945	0.235	0.060
WRCS4-014	1/4	1.285	0.300	0.090
WRCS4-516	5/16	1.375	0.312	0.190
WRCS4-038	3/8	1.725	0.385	0.370
WRCS4-012	1/2	2.130	0.465	0.596
WRCS4-058	5/8	2.405	0.540	1.000
WRCS4-034	3/4	2.630	0.560	1.500
WRCS4-078	7/8	3.150	0.630	2.000
WRCS4-001	I	3.500	0.630	2.500

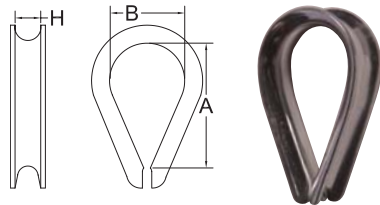
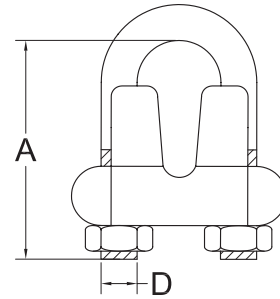

Cosses standards (acier inoxydable 304) STANDARD THIMBLES (STAINLESS STEEL 304)

Code régulier 304	Pour câble diamètre po.	Poids / ch. approx. lbs.	Dimensions po.		
			A	B	H
STDTS4-018	1/8	.006	.709	.394	.157
STDTS4-316	3/16	.014	.827	.512	.236
STDTS4-014	1/4	.024	1.063	.591	.276
STDTS4-516	5/16	.056	1.496	.866	.354
STDTS4-038	3/8	.073	1.614	.945	.394
STDTS4-012	1/2	.139	2.080	1.142	.551
STDTS4-058	5/8	.276	2.638	1.574	.709
STDTS4-034	3/4	.588	3.150	1.968	.866
STDTS4-078	7/8	.625	3.543	2.205	.945
STDTS4-001	I	.735	4.724	2.953	1.181

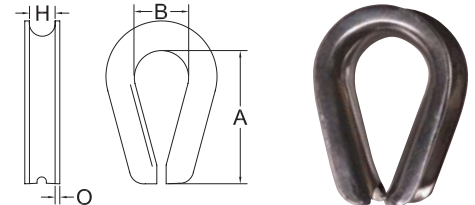

Cosses ultra-robustes (acier inoxydable 316) HEAVY DUTY THIMBLES (STAINLESS STEEL 316)

Code ultra-robuste 316	Pour câble diamètre po.	Poids / ch. approx. lbs.	Dimensions po.			
			A	B	H	O
HDS6FS-316	3/16	0.04	1.35	0.71	0.23	0.05
HDS6FS-014	1/4	0.08	1.60	0.90	0.28	0.07
HDS6FS-516	5/16	0.14	1.85	1.08	0.35	0.07
HDS6FS-038	3/8	0.25	2.00	1.12	0.40	0.11
HDS6FS-012	1/2	0.53	2.62	1.52	0.55	0.15
HDS6FS-058	5/8	0.70	3.00	1.78	0.65	0.15
HDS6FS-034	3/4	1.25	3.83	2.02	0.85	0.22
HDS6FS-078	7/8	1.50	4.08	2.30	0.95	0.22
HDS6FS-001	I	2.50	4.80	2.56	1.12	0.22

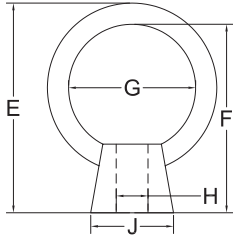

Écrous à oeil (acier inoxydable) EYE NUTS (STAINLESS STEEL)

Code	Charge maximale lbs.	Poids / ch. lbs.	Dimensions po.				
			E	F	G	H	J
ENS-014	400	0.04	1.20	1	0.62	1/4	0.50
ENS-516	700	0.08	1.55	1 5/16	0.75	5/16	0.62
ENS-038	1,000	0.13	1.92	1 5/8	0.97	3/8	0.76
ENS-012	2,000	0.26	2.38	2	1.17	1/2	0.95
ENS-058	3,200	0.53	2.81	2 1/2	1.34	5/8	1.19
ENS-034	4,700	0.75	3.36	2 3/4	1.57	3/4	1.32

Facteur de sécurité 5:1

Boulons à oeil (acier inoxydable 316) LIFTING EYE BOLTS (STAINLESS STEEL 316)

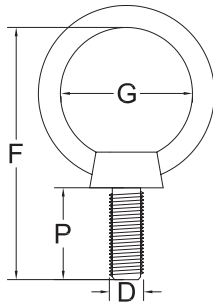

Code	Charge maximale lbs.	Poids / ch. lbs.	Dimensions po.			
			D	F	G	P
LEBS-014916	400	0.05	1/4	1 7/16	5/8	9/16
LEBS-516916	700	0.07	5/16	1 5/8	3/4	9/16
LEBS-0381116	1,000	0.13	3/8	2 1/8	15/16	11/16
LEBS-012078	2,000	0.30	1/2	2 7/16	1 1/8	7/8
LEBS-0581116	3,200	0.45	5/8	2 15/16	1 5/16	1 1/16
LEBS-034118	4,700	0.79	3/4	3 5/16	1 9/16	1 1/8
LEBS-034002	4,700	0.79	3/4	4 7/16	1 9/16	2
LEBS-0011516	7,500	1.65	1	4 1/2	2	1 5/16

Facteur de sécurité 5:1

Boulons à oeil avec écrou - épaulement (acier inoxydable 316) SHOULDER NUT EYE BOLTS (STAINLESS STEEL 316)

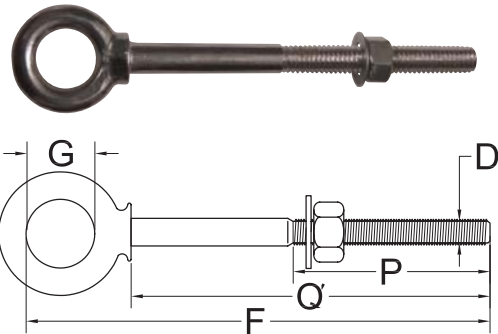

Code	Charge maximale lbs.	Poids / ch. lbs.	Dimensions po.				
			D	F	G	P	Q
SNEBS-014004	370	0.06	1/4	4 13/16	.495	2 5/8	4
SNEBS-516412	625	0.13	5/16	5 7/8	.620	2 7/16	4 1/2
SNEBS-038412	930	0.20	3/8	5 1/4	.759	2 1/2	4 1/2
SNEBS-012006	1,700	0.33	1/2	7 3/4	1.021	3	6

Facteur de sécurité 5:1

Boulons à oeil avec écrou - épaulement - ultra-robustes (SS 316) SHOULDER NUT EYE BOLTS HEAVY DUTY (STAINLESS STEEL 316)

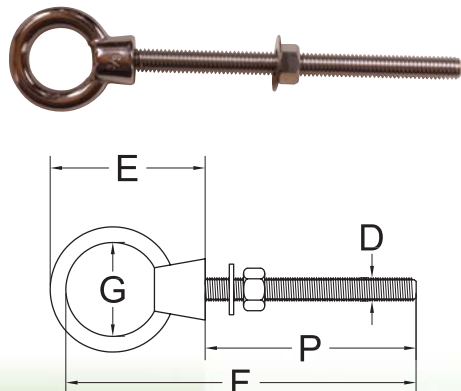

Code	Charge maximale lbs.	Poids / ch. lbs.	Dimensions po.				
			D	E	F	G	P
HDSNEBS-014002	400	0.07	1/4	1.20	3	0.62	2.00
HDSNEBS-516004	700	0.16	5/16	1.55	5 1/4	0.75	4.00
HDSNEBS-038005	1,000	0.29	3/8	1.92	6 5/8	0.97	5.00
HDSNEBS-012006	2,000	0.61	1/2	2.38	7 7/8	1.17	6.00
HDSNEBS-058006	3,200	1.10	5/8	2.81	8 1/4	1.34	6.00
HDSNEBS-034006	4,700	1.60	3/4	3.36	8 5/8	1.57	6.00
HDSNEBS-001009	7,000	3.78	1	3.55	11 1/2	2.00	9.00

Facteur de sécurité 5:1

Embouts filetés Ben-Mor (acier inoxydable)

BEN-MOR THREADED STUDS (STAINLESS STEEL)

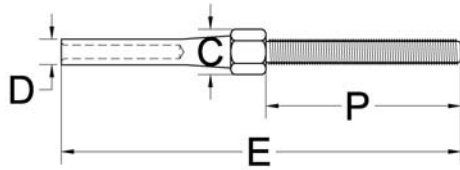

Code	Pour câble diamètre	Filet D NF-3A ou UNF-3A	Dimensions po.					
			C	D avant pressage	D après pressage	E avant pressage	E après pressage	P
BM21259-2	1/16	6-40	.188	.160	.138	2.473	2.650	1.045
BM21259-3	3/32	10-32	.250	.218	.190	2.879	2.996	1.204
BM21259-4	1/8	1/4-28	.313	.250	.219	3.333	3.589	1.376
BM21259-5	5/32	1/4-28	.313	.297	.250	3.627	3.972	1.376
BM21259-6	3/16	5/16-24	.375	.359	.313	4.002	4.170	1.458
BM21259-7	7/32	3/8-24	.438	.427	.375	4.516	4.812	1.625
BM21259-8	1/4	3/8-24	.500	.494	.438	4.937	5.236	1.750
BM21259-9	9/32	7/16-20	.625	.563	.500	5.391	5.750	1.875
BM21259-10	5/16	1/2-20	.688	.635	.563	5.844	6.266	2.000
BM21259-12	3/8	9/16-18	.750	.703	.625	6.656	7.069	2.250
BM21259-14	7/16	5/8-18	.812	.781	.688	7.437	7.910	2.500
BM21259-16	1/2	5/8-18	.875	.844	.750	8.187	8.742	2.500

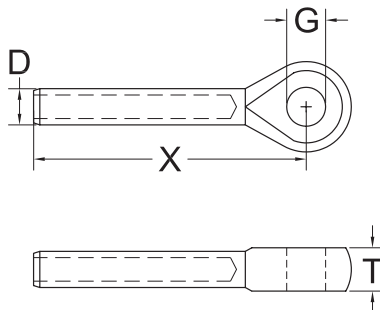

Embouts marins à oeil EY1 (acier inoxydable)

MARINE EYES EY1 (STAINLESS STEEL)

Code	Pour câble diamètre po.	Poids / ch. lbs.	Dimensions po.					
			D avant pressage	D après pressage	G avant pressage	T avant pressage	X avant pressage	X après pressage
EY1-2	1/16	.015	0.160	0.138	0.264	0.218	1.500	1.809
EY1-3	3/32	.028	0.218	0.190	0.264	0.218	1.758	2.070
EY1-4	1/8	.033	0.250	0.219	0.264	0.218	2.088	2.401
EY1-5	5/32	.055	0.297	0.250	0.327	0.281	2.355	2.709
EY1-6	3/16	.090	0.359	0.313	0.389	0.359	2.750	3.147
EY1-7	7/32	.150	0.427	0.375	0.452	0.406	3.220	3.787
EY1-8	1/4	.250	0.494	0.488	0.514	0.468	3.625	4.282
EY1-9	9/32	.330	0.563	0.500	0.514	0.468	3.795	4.514
EY1-10	5/16	.500	0.635	0.563	0.640	0.593	4.495	5.274
EY1-12	3/8	.670	0.703	0.625	0.640	0.593	4.930	5.659
EY1-14	7/16	1.00	0.781	0.688	0.765	0.719	6.375	6.750
EY1-16	1/2	1.25	0.844	0.750	0.890	0.844	7.375	7.587



OEIL & OEIL



MÂCHOIRE & MÂCHOIRE



CROCHET & CROCHET



Tendeurs moulés (acier inoxydable 316)

PRECISION CAST TURNBUCKLES (STAINLESS STEEL 316)

Code O & O	Code M & M	Dim. Diamètre x Ajust. po.	Charge maximale lbs.	Code C & C	Dim. Diamètre x Ajust. po.	Charge maximale lbs.	Poids / ch. lbs.
			O & O / M & M			C & C	
TEES-316214	TJJS-316214	3/16 x 2 1/4	300	THHS-316212	3/16 x 2 1/2	100	0.10
TEES-014234	TJJS-014234	1/4 x 2 3/4	440	THHS-014003	1/4 x 3	200	0.20
TEES-516334	TJJS-516334	5/16 x 3 3/4	800	THHS-516004	5/16 x 4	400	0.37
TEES-038434	TJJS-038434	3/8 x 4 3/4	1,200	THHS-038006	3/8 x 6	700	0.60
TEES-012006	TJJS-012006	1/2 x 6	2,200	THHS-012006	1/2 x 6	1,000	1.25
TEES-058008	TJJS-058008	5/8 x 8	2,800	THHS-058008	5/8 x 8	1,500	2.38
TEES-034010	TJJS-034010	3/4 x 10	3,500	THHS-034010	3/4 x 10	2,000	4.00

Facteur de sécurité 5:1

OEIL & OEIL



MÂCHOIRE & MÂCHOIRE



CROCHET & CROCHET



Tendeurs forgés (acier inoxydable 316)

FORGED TURNBUCKLES (STAINLESS STEEL 316)

Code O & O	Code M & M	Dim. Diamètre x Ajust. po.	Charge maximale lbs.	Code C & C	Dim. Diamètre x Ajust. po.	Charge maximale lbs.	Poids / ch. lbs.
			O & O / M & M			C & C	
TEES-014004F	TJJS-014004F	1/4 x 4	460	THHS-014004F	1/4 x 4	300	0.20
TEES-516412F	TJJS-516412F	5/16 x 4 1/2	780	THHS-516412F	5/16 x 4 1/2	500	0.37
TEES-038006F	TJJS-038006F	3/8 x 6	1,160	THHS-038006F	3/8 x 6	750	0.60
TEES-012006F	TJJS-012006F	1/2 x 6	2,150	THHS-012006F	1/2 x 6	1,050	1.25
TEES-058006F	TJJS-058006F	5/8 x 6	3,440	THHS-058006F	5/8 x 6	1,600	2.38
TEES-034006F	TJJS-034006F	3/4 x 6	5,140	THHS-034006F	3/4 x 6	2,000	4.00

Facteur de sécurité 5:1



Mâchoire et tige pressée (acier inoxydable 316)

JAW AND SWAGE TERMINALS (STAINLESS STEEL 316)

Code	Pour câble diamètre po.	Dim. Diamètre x Ajust, po.	Poids / ch. lbs.
TJS-018a	1/8	1/4 x 3 1/2	0.2
TJS-532a	5/32	1/4 x 3 1/2	0.2
TJS-532b	5/32	5/16 x 4 5/16	0.3
TJS-316a	3/16	5/16 x 4 5/16	0.3
TJS-316b	3/16	3/8 x 4 3/4	0.5
TJS-732a	7/32	3/8 x 4 3/4	0.5
TJS-014a	1/4	3/8 x 4 3/4	0.6
TJS-014b	1/4	1/2 x 5 7/8	0.6
TJS-932a	9/32	7/10 x 5 1/8	0.7
TJS-932b	9/32	1/2 x 5 7/8	1.0
TJS-516a	5/16	1/2 x 5 7/8	1.8
TJS-516b	5/16	5/8 x 7 1/2	1.9
TJS-038a	3/8	5/8 x 7 1/2	2.0
TJS-038b	3/8	3/4 x 8 5/8	3.7
TJS-012a	1/2	3/4 x 8 5/8	3.8



Manilles à goupille vissées, type «LYRE» (acier inoxydable 316)

SCREW PIN SHACKLES, BOW TYPE (STAINLESS STEEL 316)

Code	Dim. po.	Charge maximale lbs.	Poids ch. lbs.	Dimensions (po.)						
				A	B	D	G	H	L	T
SPAS-316S6	3/16	400	0.03	0.740	0.622	0.206	0.220	0.375	0.200	0.448
SPAS-014S6	1/4	720	0.06	0.820	0.960	0.232	0.268	0.526	0.225	0.500
SPAS-516S6	5/16	1,060	0.16	1.350	1.120	0.305	0.335	0.660	0.308	0.625
SPAS-038S6	3/8	1,600	0.24	1.520	1.280	0.415	0.427	0.820	0.386	0.780
SPAS-716S6	7/16	2,200	0.50	2.100	1.640	0.464	0.497	0.960	0.464	0.933
SPAS-012S6	1/2	2,800	0.40	2.000	1.520	0.450	0.520	1.060	0.462	1.010
SPAS-058S6	5/8	4,400	1.00	2.900	2.130	0.620	0.635	0.122	0.600	1.250
SPAS-034S6	3/4	6,400	1.61	2.900	2.450	0.767	0.845	1.570	0.767	1.550
SPAS-078S6	7/8	8,800	2.53	3.350	2.190	0.875	1.040	1.400	0.965	2.000
SPAS-001S6	1	15,500	3.60	4.400	3.400	0.970	1.100	2.000	0.958	2.000

Facteur de sécurité 5:1

Ne pas utiliser pour le levage. Accessoires conçus spécifiquement pour levage disponibles sur demande.

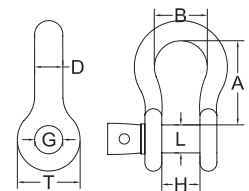

Manilles à goupille vissée, type chaîne (acier inoxydable 316)

SCREW PIN SHACKLES, CHAIN TYPE (STAINLESS STEEL 316)

Code	Dim. po.	Charge maximale lbs.	Poids ch. lbs.	Dimensions (po.)					
				A	D	G	H	L	T
SPCS-316S6	3/16	400	0.03	0.765	0.200	0.210	0.461	0.188	0.400
SPCS-014S6	1/4	720	0.06	0.820	0.230	0.260	0.480	0.226	0.425
SPCS-516S6	5/16	1,060	0.16	1.070	0.302	0.325	0.672	0.305	0.620
SPCS-038S6	3/8	1,600	0.24	1.400	0.388	0.400	0.812	0.380	0.770
SPCS-012S6	1/2	2,800	0.40	1.810	0.500	0.525	1.000	0.465	1.020
SPCS-058S6	5/8	4,400	1.00	1.900	0.586	0.637	1.250	0.626	1.150

Facteur de sécurité 5:1

Ne pas utiliser pour le levage. Accessoires conçus spécifiquement pour levage disponibles sur demande.

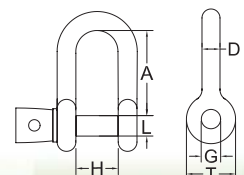

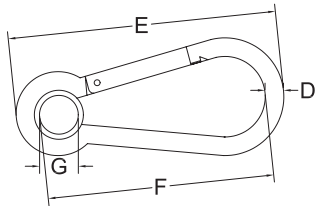

Mousquetons avec oeillet (acier inoxydable 316)

CARBINE SNAP HOOKS WITH EYELETS (STAINLESS STEEL 316)

Code	Charge maximale lbs	Poids / ch. lbs	Dimensions po.				
			D		E	F	G
			po.	mm			
S9-1	120	0.04	3/16	5	1.97	1.553	0.197
S9-2	160	0.06	1/4	6	2.36	1.918	0.197
S9-3	300	0.15	5/16	8	3.15	2.471	0.315
S9-4	400	0.32	3/8	10	3.94	3.036	0.394
S9-5	700	0.60	1/2	12	5.51	4.516	0.512

Facteur de sécurité 5:1

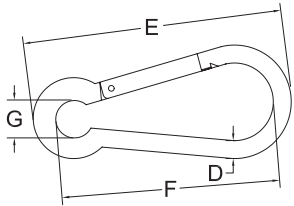

Mousquetons (acier inoxydable 316)

CARBINE SNAP HOOKS (STAINLESS STEEL 316)

Code	Charge maximale lbs	Poids / ch. lbs	Dimensions po.				
			D		E	F	G Min
			po.	mm			
S11-1	120	0.04	3/16	5	1.97	1.609	0.197
S11-2	160	0.06	1/4	6	2.36	1.945	0.197
S11-3	300	0.15	5/16	8	3.15	2.578	0.315
S11-4	400	0.32	3/8	10	3.94	3.146	0.394
S11-5	700	0.60	1/2	12	5.51	4.678	0.512

Facteur de sécurité 5:1

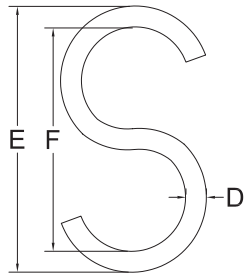

Crochets en "S" (acier inoxydable 316)

"S" HOOKS (STAINLESS STEEL 316)

Code	Poids / ch. lbs	Dimensions po.			
		D		E	F
		po.	mm		
SHS-018	0.01	1/8	3	1.35	1.142
SHS-532	0.02	5/32	4	1.61	1.116
SHS-316	0.03	3/16	5	1.98	1.490
SHS-014	0.07	1/4	6	2.10	1.809
SHS-516	0.15	5/16	8	2.42	2.075

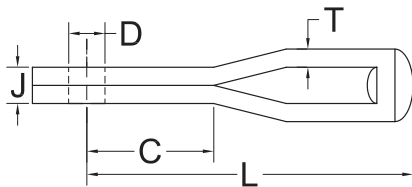

Fourchette pivotante repliée (acier inoxydable)

STAINLESS STRAP EYES (STAINLESS STEEL)

Code	Diamètre po.	Dimensions po.				
		C	D	J	L	T
2161-02	1/16	.454	.188	.088	1 1/16	.042
2161-03	3/32	.616	.188	.103	1 1/2	.049
2161-04	1/8	.638	.188	.190	1 5/8	.093
2161-05	5/32	.699	.250	.197	1 15/16	.096
2161-06	3/16	.750	.313	.255	2 3/16	.125

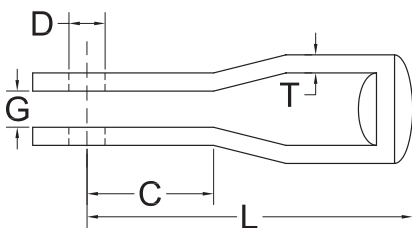

Fourchette pivotante (acier inoxydable)

STAINLESS STRAP FORKS (STAINLESS STEEL)

Code	Diamètre po.	Dimensions po.				
		C	D	G	L	T
3161-02	1/16	.454	.188	.088	1 1/16	.042
3161-03	3/32	.616	.188	.108	1 1/2	.049
3161-04	1/8	.638	.188	.195	1 5/8	.093
3161-05	5/32	.699	.250	.202	1 15/16	.096
3161-06	3/16	.750	.313	.260	2 3/16	.125



Maillons rapides (acier inoxydable 316) QUICK LINKS (STAINLESS STEEL 316)

Code	Charge maximale lbs	Poids / ch. lbs	Dimensions po.			
			A	B	D	
					po.	mm
QLS-018	450	0.03	1.00	0.335	1/8	3
QLS-316	1,200	0.06	1.40	0.512	3/16	5
QLS-014	1,400	0.09	1.77	0.571	1/4	6
QLS-516	2,400	0.18	2.28	0.689	5/16	8
QLS-038	3,200	0.28	2.72	0.808	3/8	10
QLS-012	5,500	0.70	3.17	0.925	1/2	12

Facteur de sécurité 2.5 : 1

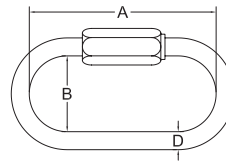

Mousquetons à oeil pivotant (acier inoxydable 316) SWIVEL EYE SNAPS (STAINLESS STEEL 316)

Code	Charge maximale lbs.	Poids / ch. lbs.	Dimensions po.	
			F	H
S2-1	120	0.128	3 5/16	3/4
S2-2	150	0.204	3 7/8	3/4

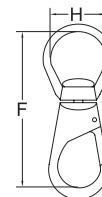

Mousquetons à oeil fixe (acier inoxydable 316) FIXED EYE SNAPS (STAINLESS STEEL 316)

Code	Charge maximale lbs.	Poids / ch. lbs.	Dimensions po.	
			F	H
S1-1	140	0.052	2 1/16	3/8
S1-2	240	0.106	2 7/8	5/8
S1-3	320	0.165	3 5/16	3/4

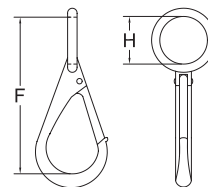

Mousquetons de sécurité (acier inoxydable 316) SAFETY SNAP HOOKS (STAINLESS STEEL 316)

Code	Charge maximale lbs.	Poids / ch. lbs.	Dimensions po.	
			F	H
S7-1	500	0.26	4 1/8	3/4
S7-2	600	0.42	4 3/4	1 1/8

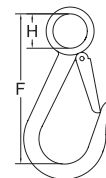

Crochets pivotants (acier inoxydable 316) SWIVEL HOOKS (STAINLESS STEEL 316)

Code	Charge maximale lbs	Poids ch. lbs.	Dimensions po.				
			B	D	E	F	H
SH4-014	770	0.42	0.87	1/4	4.65	3.607	0.68
SH5-516	1,430	0.72	1.10	5/16	5.50	4.210	0.76
SH6-038	2,200	1.16	1.10	3/8	6.25	4.752	0.79
SH8-012	3,300	2.34	1.42	1/2	7.87	5.875	1.18

Facteur de sécurité 4:1

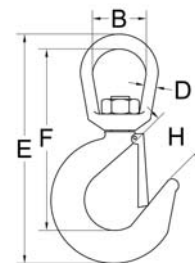

Crochets à oeil (acier inoxydable 316) EYE HOOKS (STAINLESS STEEL 316)

Code	Pour chaîne dim. po.	Charge maximale lbs	Poids / ch. lbs.	Dimensions po.			
				D	F	G	H
EHS-014	1/4	900	0.35	1/4	2.54	0.53	0.68
EHS-516	5/16	1,250	0.55	5/16	2.85	0.64	0.70
EHS-038	3/8	2,000	0.92	3/8	3.28	0.71	0.80
EHS-012	1/2	3,000	1.90	1/2	4.17	0.94	1.02

Facteur de sécurité 5:1

